

PR SB401

ITEM NO:77500256

PR SB401-R 1/10 Electric 4wd Off Road Buggy Kit Lightweight Edition
(Slipper Clutch Version)

PR RACING
TYPE 



PR racing have been hard at work developing the next generation of the successful SB401 platform and have made the SB401-R faster, quieter and easier to maintain and tune. A number of key components have been totally redesigned to produce a better handling and more forgiving car to drive. The main focus has been on the all new narrow 2mm 7075-T6 chassis and plastic side-pods, which utilizes a carbon fibre re-enforced spine to control torsional and longitudinal flex. The additional flex has proved to increase grip, and make the car feel more balanced and easier to drive leading to faster, more consistent laps.

HEALTH WARNING

This model is a high-performance radio controlled racing product that is designed for use on R/C car race tracks. If it is misused it could cause injury to the operator or others. Many of the items in this kit are small enough to be accidentally swallowed; therefore, it is not suitable for young children. All items, inclusive of liquids, contained in this kit are not intended for human consumption. Rotating parts of the car may cause injury if not handled with care.

Name: PR SB401-R 1/10 Electric 4wd Off Road Buggy Kit

PR racing have been hard at work developing the next generation of the successful SB401 platform and have made the SB401-R faster, quieter and easier to maintain and tune.

A number of key components have been totally redesigned to produce a better handling and more forgiving car to drive. The main focus has been on the all new narrow 2mm 7075-T6 chassis and plastic side-pods, which utilizes a carbon fibre re-enforced spine to control torsional and longitudinal flex. The additional flex has proved to increase grip, and make the car feel more balanced and easier to drive leading to faster, more consistent laps.

Chassis

- Hard anodised 2mm 7075-T6 Narrow chassis with side-pods
- Plastic/carbon chassis spine with CNC alloy bulkheads
- Alloy/Carbon floating servo mount
- Improved weight distribution with motor and slipper 10mm forward
- Type R ultra-low CofG Body

Transmission

- New stronger/quieter pinions and ring gears
- New vented slipper assembly with ultra-hard shafts and cups for long life
- Top loading slipper/centre diff mount for easy access
- Longer diff cups to allow for more droop

Suspension and Steering

- 12.75mm Type R shocks
- Lower towers for ultra-low CofG
- Suspension hangers with inserts for toe and anti-squat adjustment
- Revised Ackerman geometry for improved steering feel
- New shock seal caps and seals for ultra-smooth operation
- 11 Degree CNC caster blocks
- CNC alloy rear hubs
- Gullwing rear wishbones
- Hard front wishbones
- New shorter grey ball-cups
- New high tensile steel turnbuckles

Specifications

Type: 1/10th 4wd Off-Road

Power Source: Electric

Wheelbase:287mm(variable)

Width:245mm-248mm

Gear Ratio: 2.6:1

Weight 1720g race ready (varies)

Hardware: Full metric

Bearings: Sealed Metal Ball Bearings

Wheels: 12mm hex

Kit: Assembly required

Items Required to Complete

2 Channel surface frequency radio system

2S LiPo battery & compatible lipo charger

1/10 ESC, motor & pinion gear

High-Speed Servo

1/10 tyres and inserts

Tools, paint for polycarbonate body, tyre glue, threadlock

Silicon diff and shock oil



- **BEFORE INSTALLATION** ----- 01
- **BAG A** ----- 03-07 ● **BAG E** ----- 19-21
 - A1-Main Chassis Assembly- Chassis Brace Installation
 - A2-Gear Diff Assembly
 - A3-Slipper Assmebly
 - A4-Gear Box Assembly
 - A5 Rear Central Transmission
 - E1-Front & Rear Shock Assembly-R
 - E2-Front & Rear Shock Installation
 - E3-Motor Installation
 - E4-Mounting Tires, Wheel Installation
- **BAG B** ----- 08-11
 - B1-Suspension Mount Installation
 - B2-Front Hub Carrier Assembly(Left Side)
 - B3-Suspension Mount Installation-Sway Bar Installation
 - B4-Front Upper Turnbuckle Assembly
 - B5-Gearbox-Reinforcement - Front
- **BAG C** ----- 12-15
 - C1 Rear Assembly
 - C2-3-Rear Left Hub Carrier Assmebly
 - C4-Rear Upper Rod -Turnbuckle Assembly
 - C5-Sway Bar Installation
- **BAG D** ----- 16-18
 - D1-Bell Crank Installation
 - D2- Steering
 - D3-Turnbuckle Assembly-Steering Rod -Servo Rod
 - D4-Servo Installation
 - D5-Center Mount Plate
 - D6-Battery Plate Installation
- **EXPLOSION PICTURE** ----- 22
- **SETUP SHEET** ----- 23

BEFORE INSTALLATION

- 1 Read through the instruction manual before installation in order to have an overview of what to do.
- 2 Check if there is any missing bags or defective parts, if there is, please contact our local dealer or our PR Distributor.
- 3 Symbols used throughout the instruction manual, comprises of:



Part bags used.



Assemble as many times as specified (here: twice).



Tighten securely.



Note the direction.



True-to-scale diagram.



Do not over tighten.



Must be purchased separately.



Apply threadlocker (screw cement)



Ensure smooth non-binding movement while assembling.



Assemble in the specified order.



Apply grease.



Cut off shaded portion.



Assemble left and right sides the same way.



Apply oil.

- 4 This kit contains screws and hardware in diifferent metric sizes and shapes. Before using them, check the screws on the true-to-scale diagrams on the left side in each assembly step. Some screw are extras.

TOOLS REQUIRED

CAUTION: Handle tools carefully!

- Needle Nose Pliers

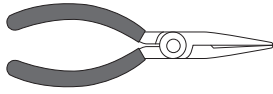

- Awl

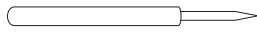

- Grease



- Screw Cement



- Round Cutter & Sander

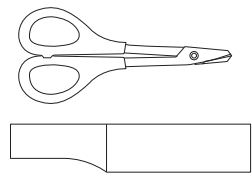

- Sharp Hobby Knife

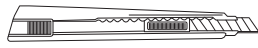

- Wire Cutters



For trimming bodies Cutting along curved lines was never so easy!

- Hex Wrench

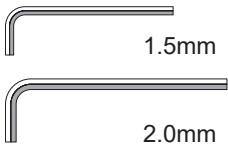

- Ball Differential Grease



- SP Knife Edge Reamer

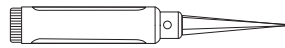

Do not pre-drill as precise drilling of 1mm to 15mm holes can be performed after body shell painted.

RADIO PREPARATION

- A new battery must be charged before it is used. Refer to the charger instruction manual for charging.
- Set up the radio control system as indicated below.

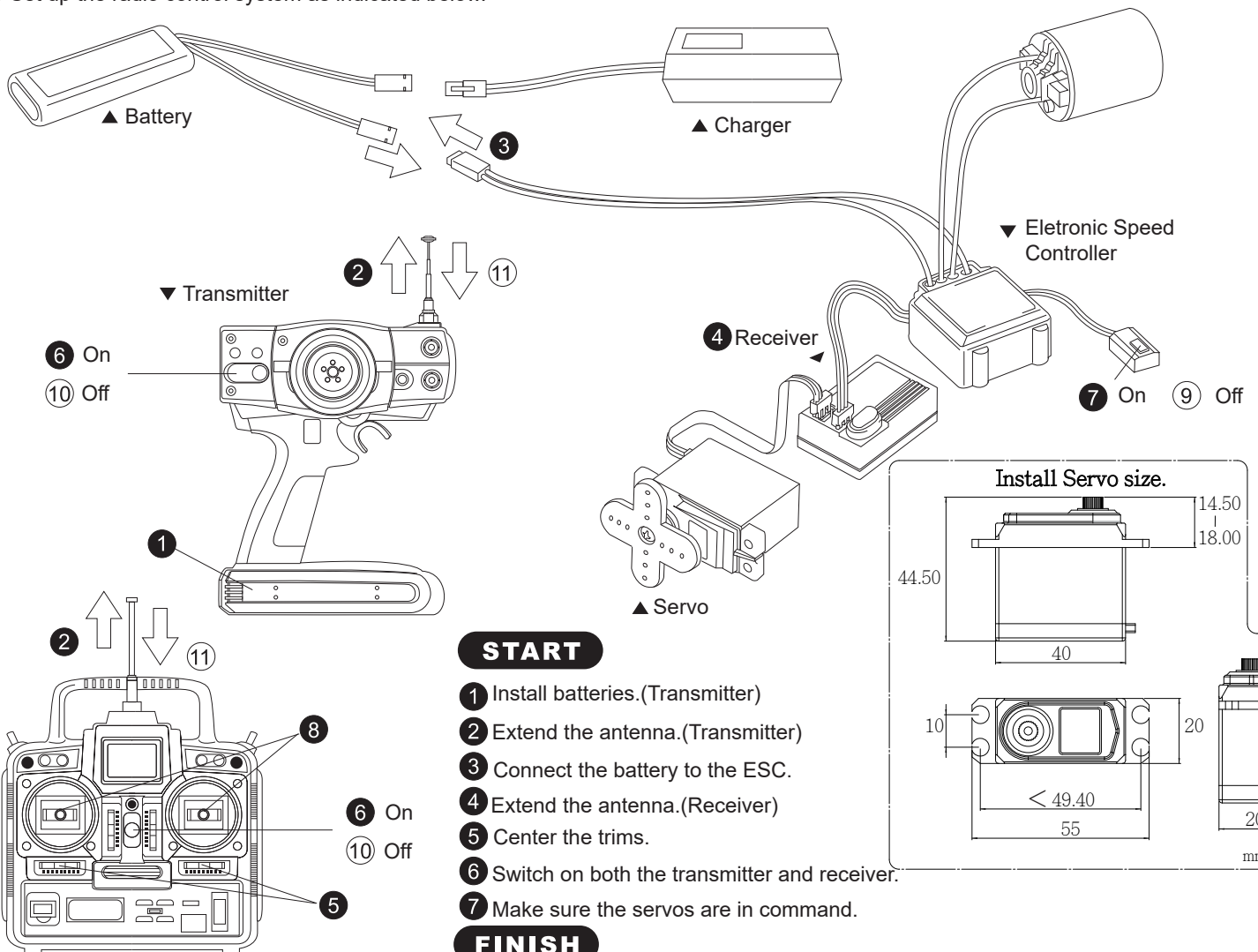

START

- 1 Install batteries.(Transmitter)
- 2 Extend the antenna.(Transmitter)
- 3 Connect the battery to the ESC.
- 4 Extend the antenna.(Receiver)
- 5 Center the trims.
- 6 Switch on both the transmitter and receiver.
- 7 Make sure the servos are in command.

FINISH

- 8 Switch off both the transmitter and receiver.
- 9 Retract the antenna. (Transmitter)

A1 Chassis Brace Installation Main Chassis Assembly

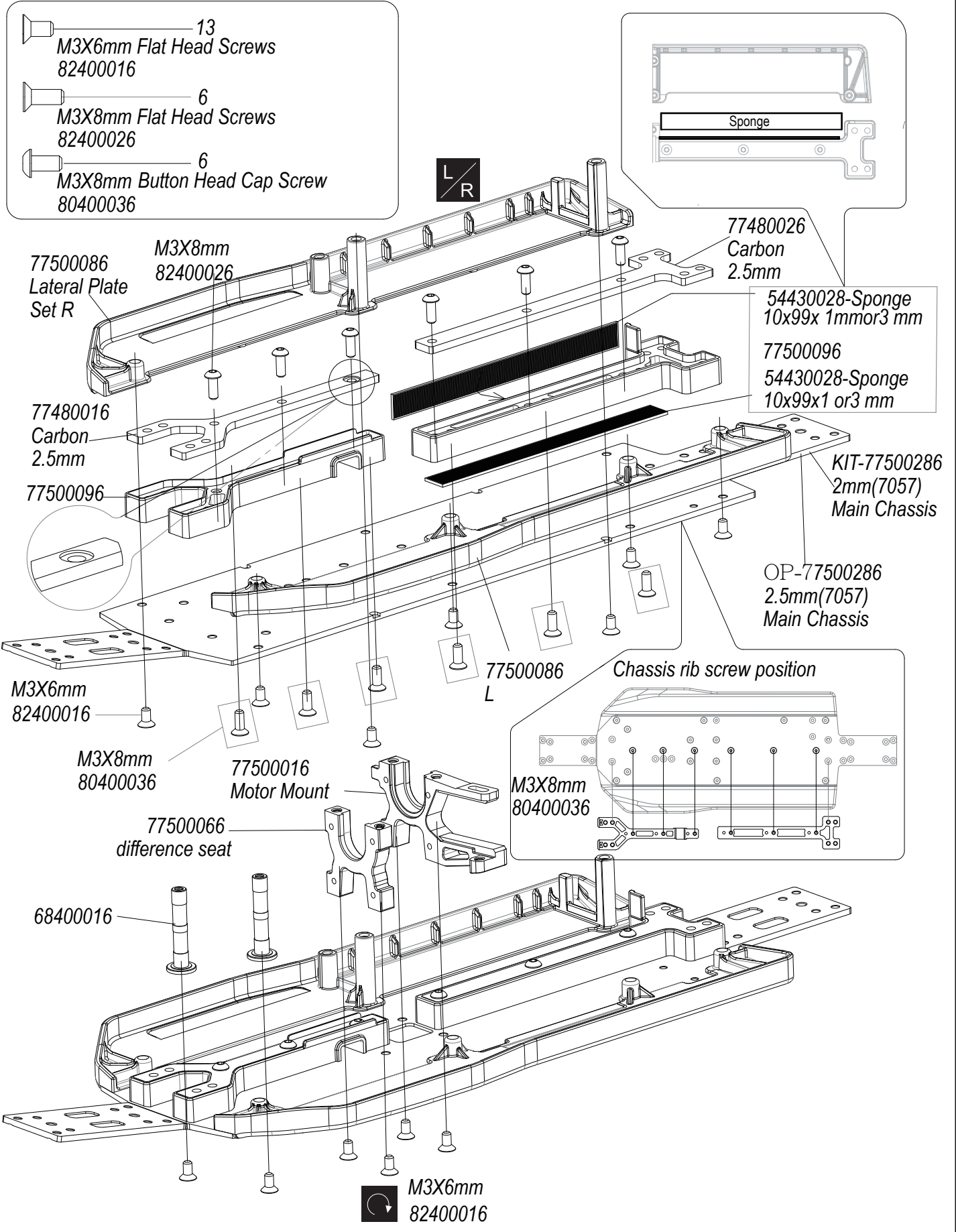



BAG A

A2 Gear Diff Assembly

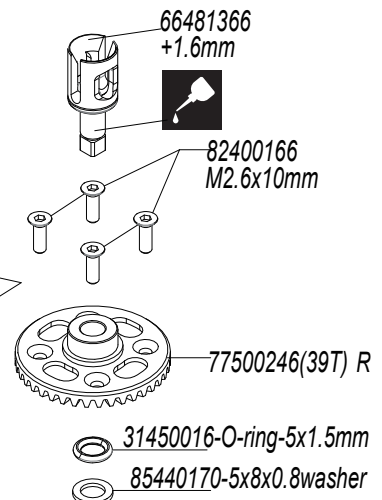
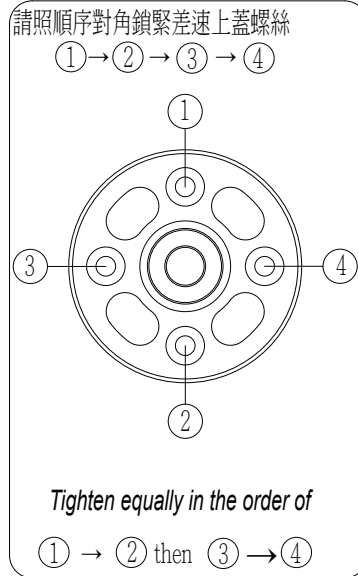
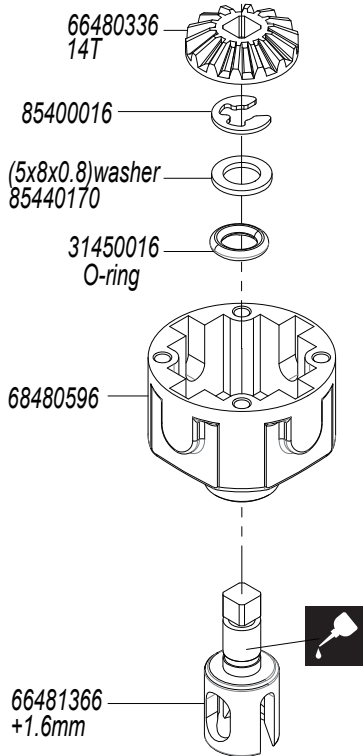
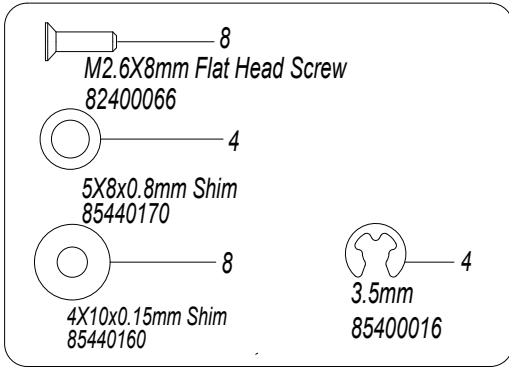

x2

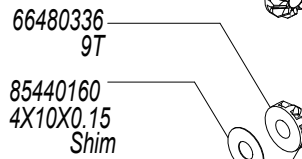

According to the different track, you can choose to use 2 gears or 4 gears

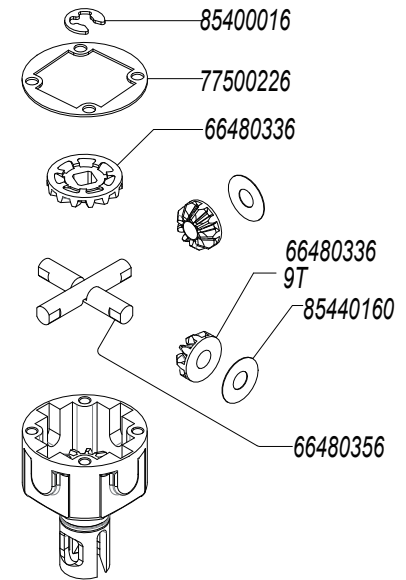

Assemble 1 front and 1 rear

Diff Oil
Silicon Oil

80% oil max

After first drive
adjust
for track conditions

SILICON DIFF OIL
7000 F
7000 R

Pour in the oil until the gears are just submerged in oil.



Part Bags used.



Apply oil.



Assemble as many times as specified (here:twice).



Assemble in the specified order.

A3 Slipper Assmely



ITEM NO:77500256

PR SB401-R 1/10 Electric 4wd Off Road Buggy Kit Lightweight Edition (Slipper Clutch Version)

- 1 M3X3mm Set Screw 87400016
- 1 M3X6mm Flat Head Screw 82400016
- 1 Pin - 2 x 7.8mm -79400096
- 2 Pin - 2 x 10.8mm -79400016
- 2 10x15x4mm-zz Ball Bearing 89430030
- 1 10X12.5X0.1-85440230
- 1 Shim 3x5x0.3mm -85440290

Tighten the slipper nut until the spring is completely compressed, to break it in first. Then adjust the slipper.

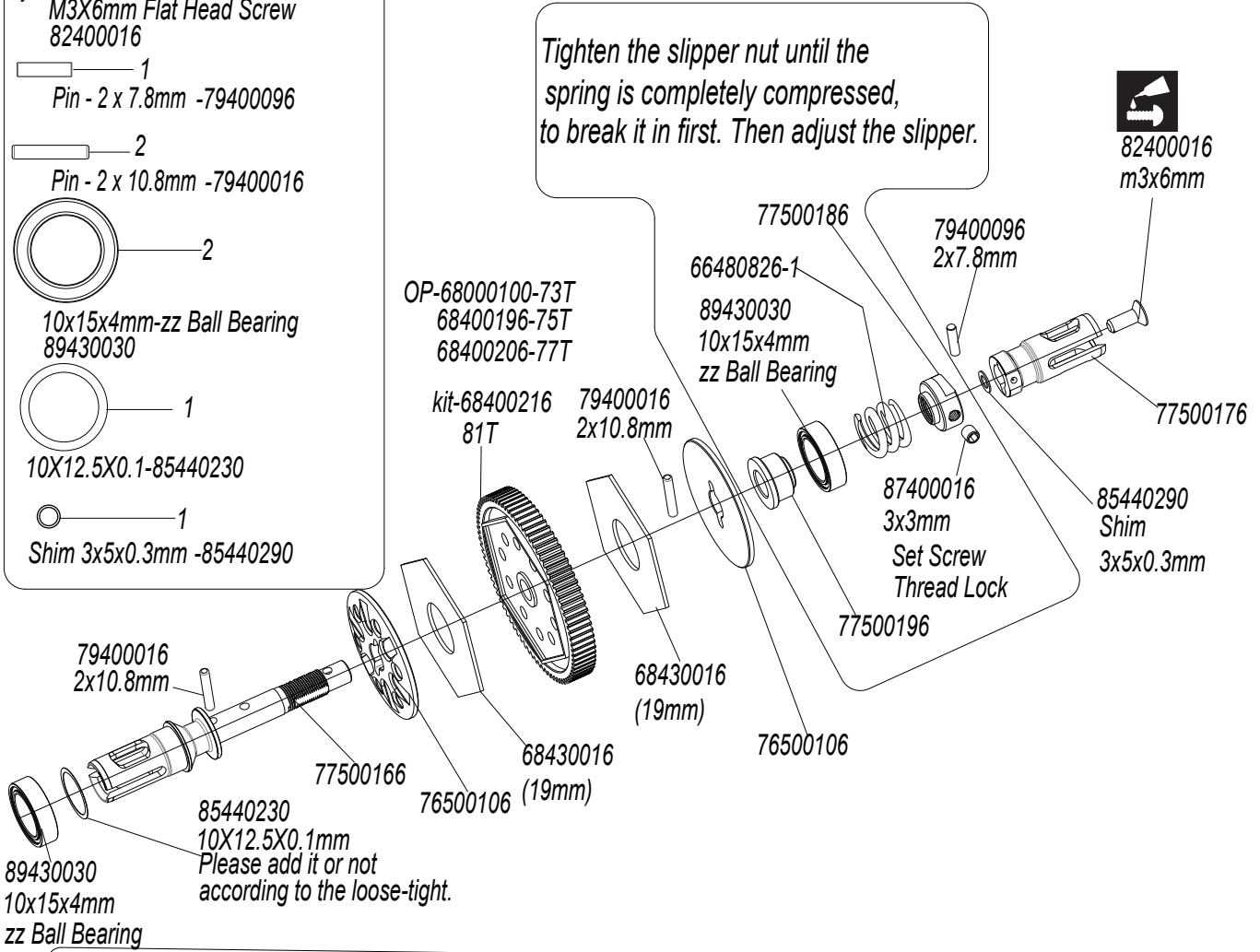

The set screw used to secure the slipper nut is tightened onto the flat area of the slipper shaft *Do not tighten onto the threaded area. Please tighten the area on the marked point

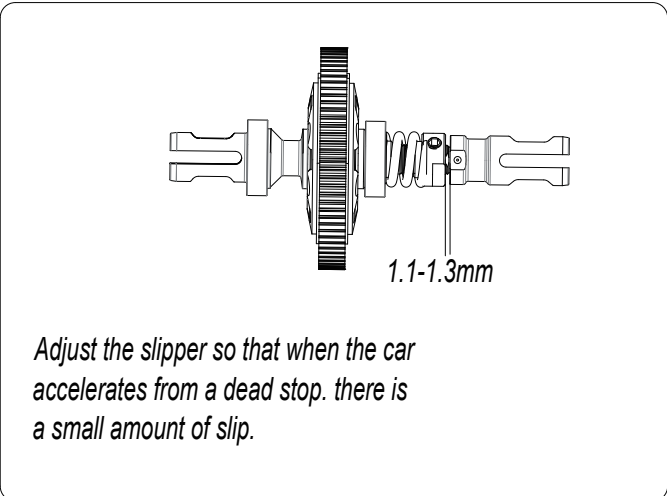
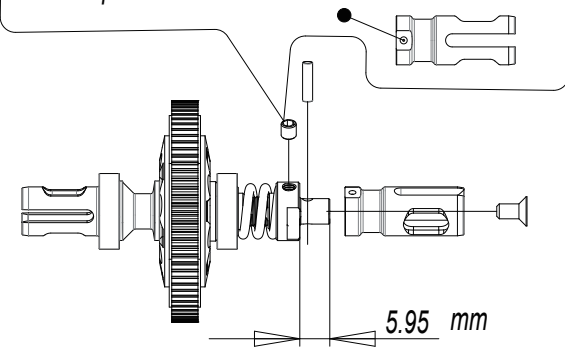



A4 Gear Box Assembly Front Front Shock Tower nstallation

Front

BAG A

- 2
4.8x8mm Ball Studs-68430046
- 2
M3 Lock Nut -83400106
- 6
M3X10mm Button Head Cap Screw
80400046
- 1
M4X3mm Set Screw-78400016
- 2
5x8x0.1mm-Shim-85440090
- 3
10X12.5X0.1-Shim-85440230
- 2
5x10x4mm
zz Ball Bearing-89430010
- 2
10x15x4mm
zz Ball Bearing-89430030
- 1
79400086(2x9.8mm)

組裝時請注意齒輪方向
Please notice the direction
of gear.

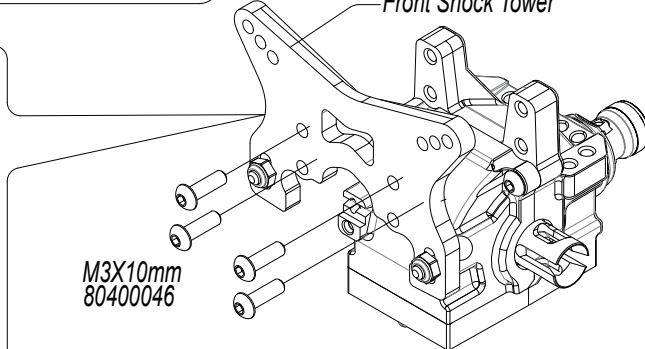
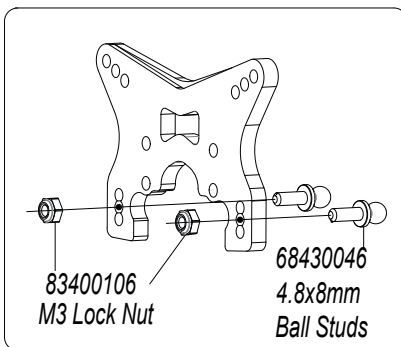
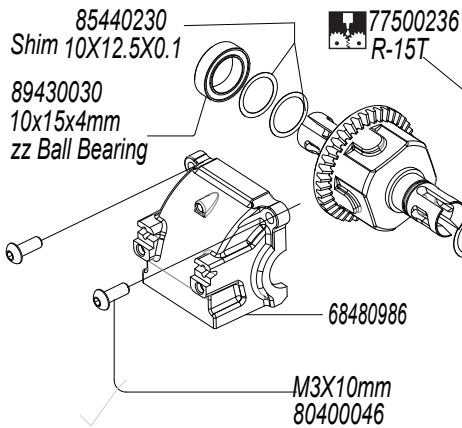
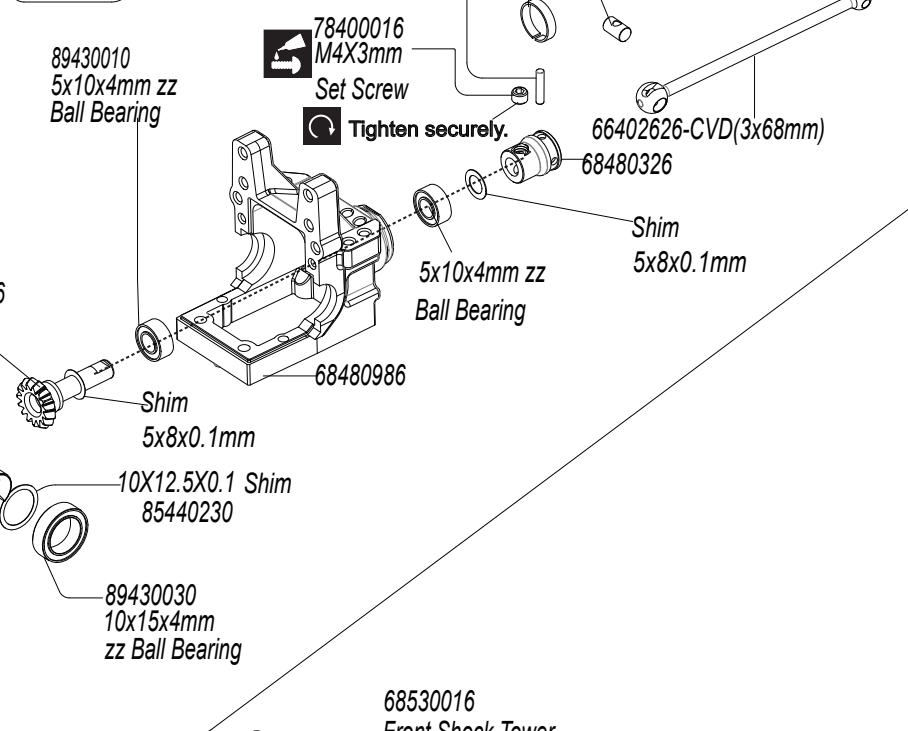
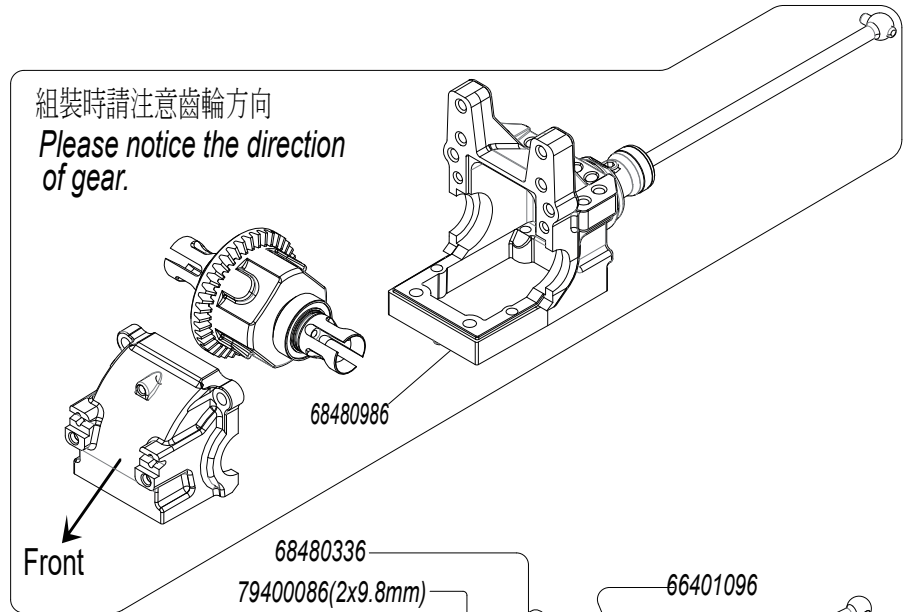



BAG A

A5 Gear Box Assembly Front Rear Shock Tower Installation

Rear

- 2
4.8x8mm Ball Studs-68430046
- 2
M3 Lock Nut -83400106
- 6
M3X10mm Button Head Cap Screw 80400046
- 1
M4X3mm Set Screw-78400016
- 2
5x8x0.1mm Shim 85440090
- 3
10X12.5X0.1-85440230 Shim
- 2
5x10x4mm Ball Bearing 89430010
- 2
10x15x4mm Ball Bearing 89430030
- 1
(2x9.8mm)-79400086

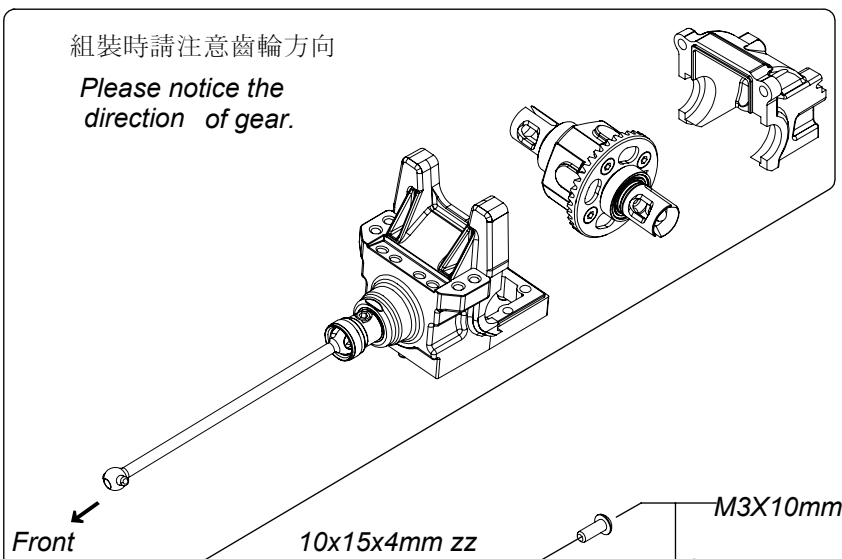

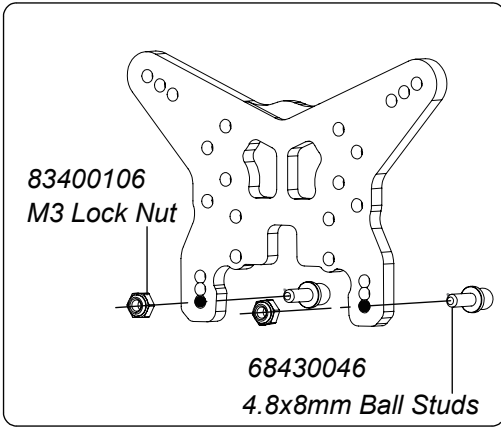
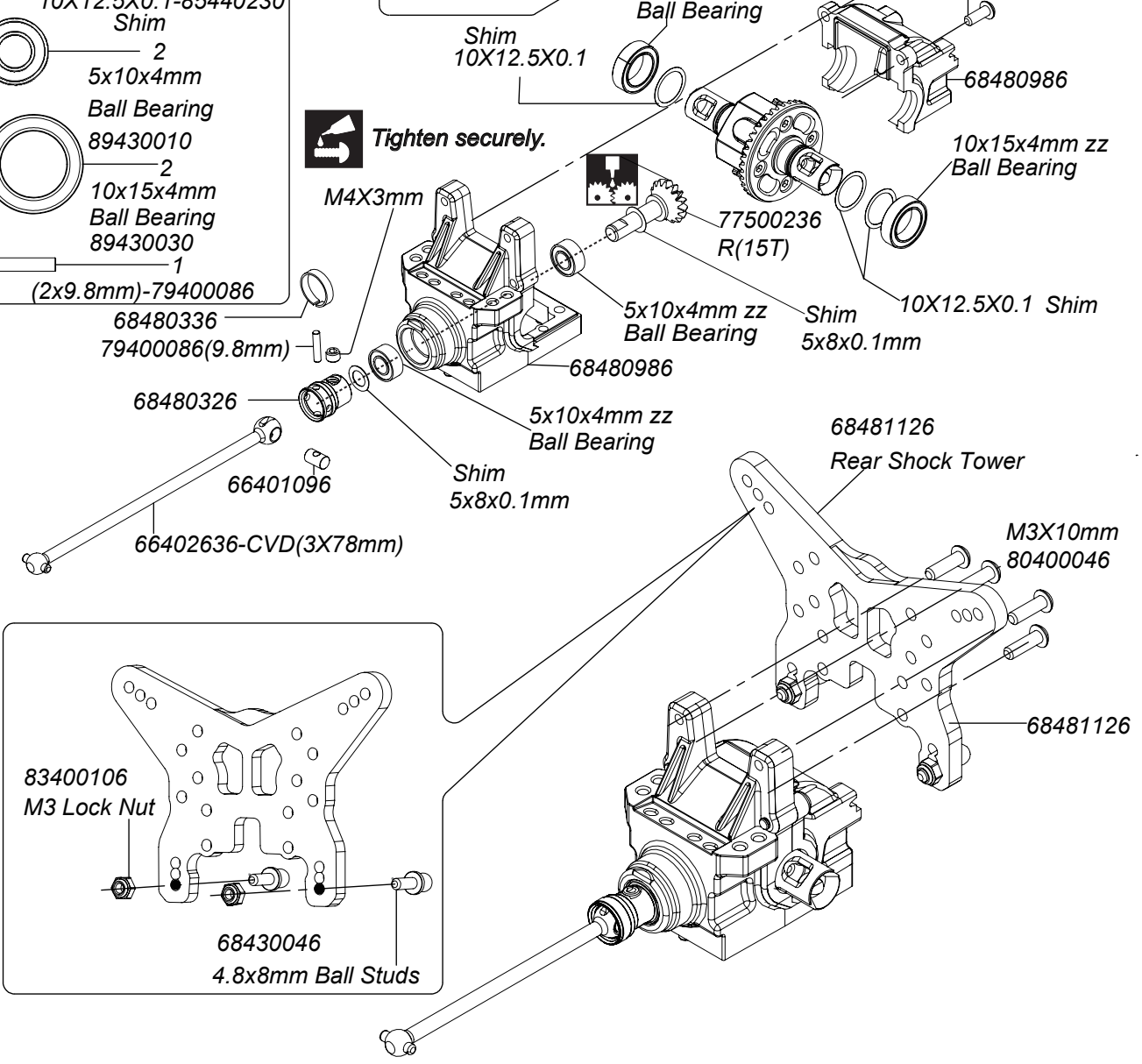

Tighten securely.



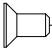
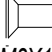

BAG B

B1 Suspension Mount Installation

-  2
M3X6mm Flat Head Screw
82400016
-  2
M3X10mm Flat Head Screw
82400106
-  2
M3X15mm Flat Head Screw
82400176

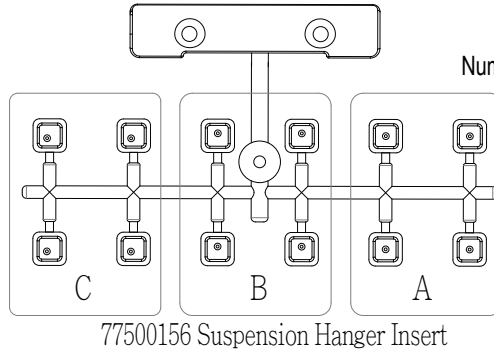

77500116
FR Suspension Mount

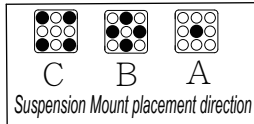

FRONT HANGER INSERTS

Numbering	FF	FR	TOE	SQUAT
F-1			0	0
F-2			0	+0.7
F-3			0	+1.4
F-4			0	-0.7
F-5			0	0
F-6			0	+0.7
F-7			0	-1.4
F-8			0	-0.7
F-9			0	0
F-10			0	0
F-11			-0.9	0
F-12			-1.7	0
F-13			+0.9	0
F-14			0	0
F-15			-0.9	0
F-16			+1.7	0
F-17			+0.9	0
F-18			0	0
R-19			+3.5	+2

Note:  (1) SB401 Plastic Antisquat Shims=1mm=1Degree.

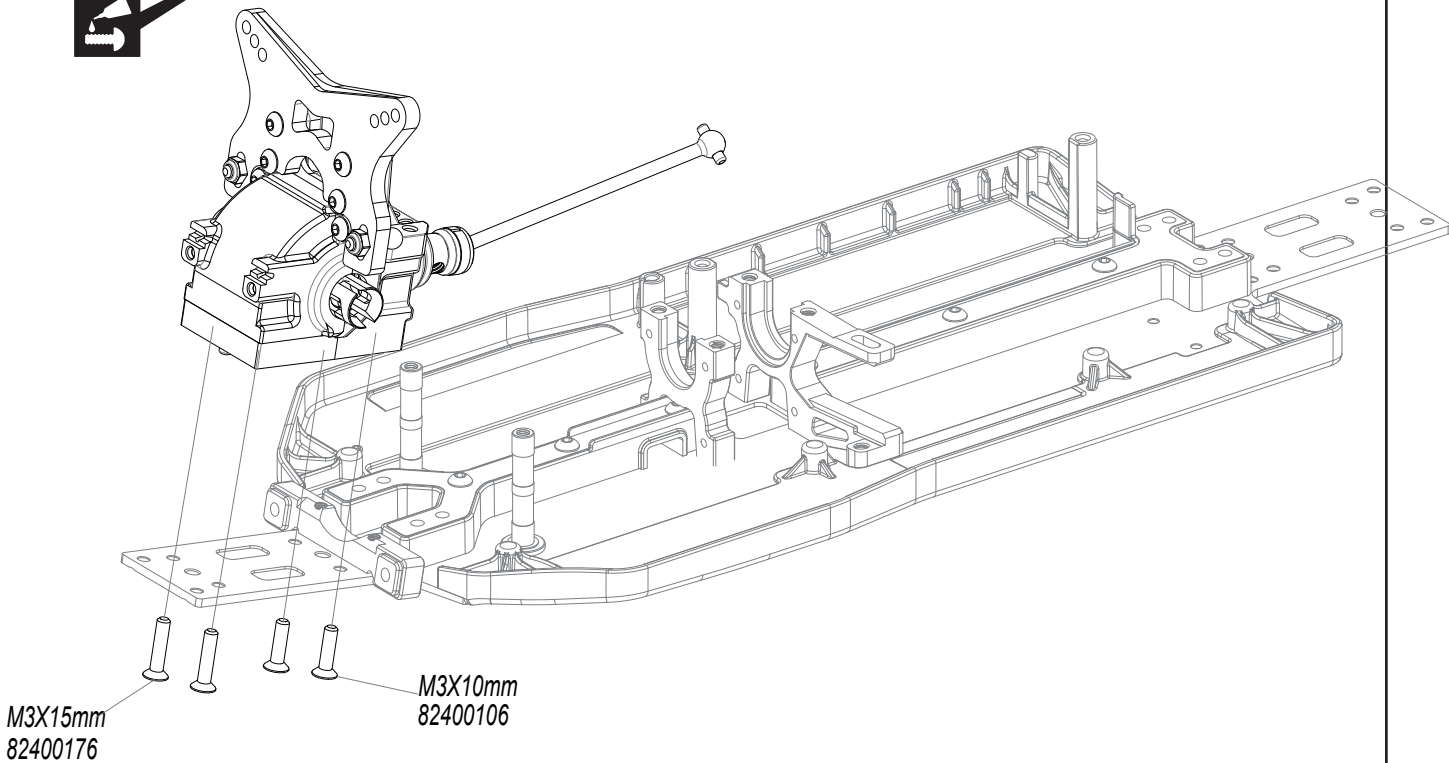
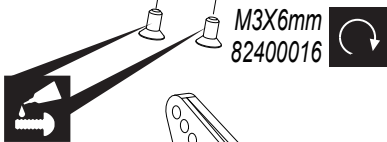
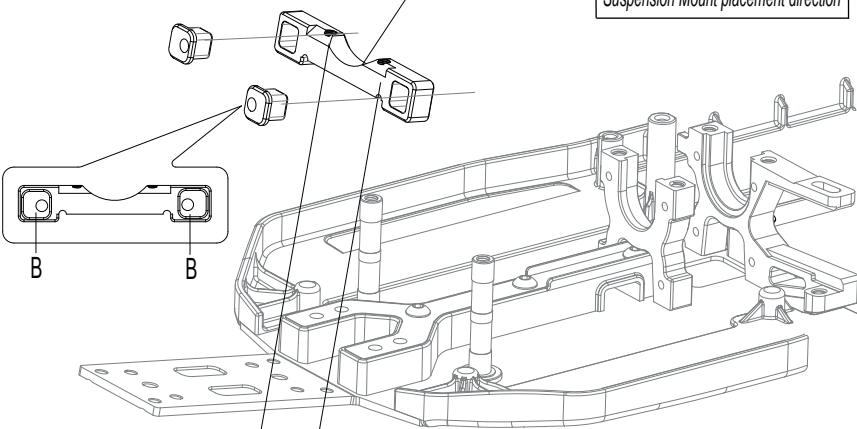



B2 Front Hub Carrier Assembly (Left Side)

Left Side



- 2
Button Head Cap-80400206
Screw M3x12mm
- 2
4.8mmx6mm-68430036
Ball Studs
- 1
5x10x4mm zz Ball Bearing
89430010
- 1
5X13X4mm zz Ball Bearing
89430020
- 1
Pin2x9.8mm-79400086
- 1
Pin-2 x10.8mm-79400086
- 2
Shim 5x8x0.1mm-85440090
- 1
m2X5mm-87400066

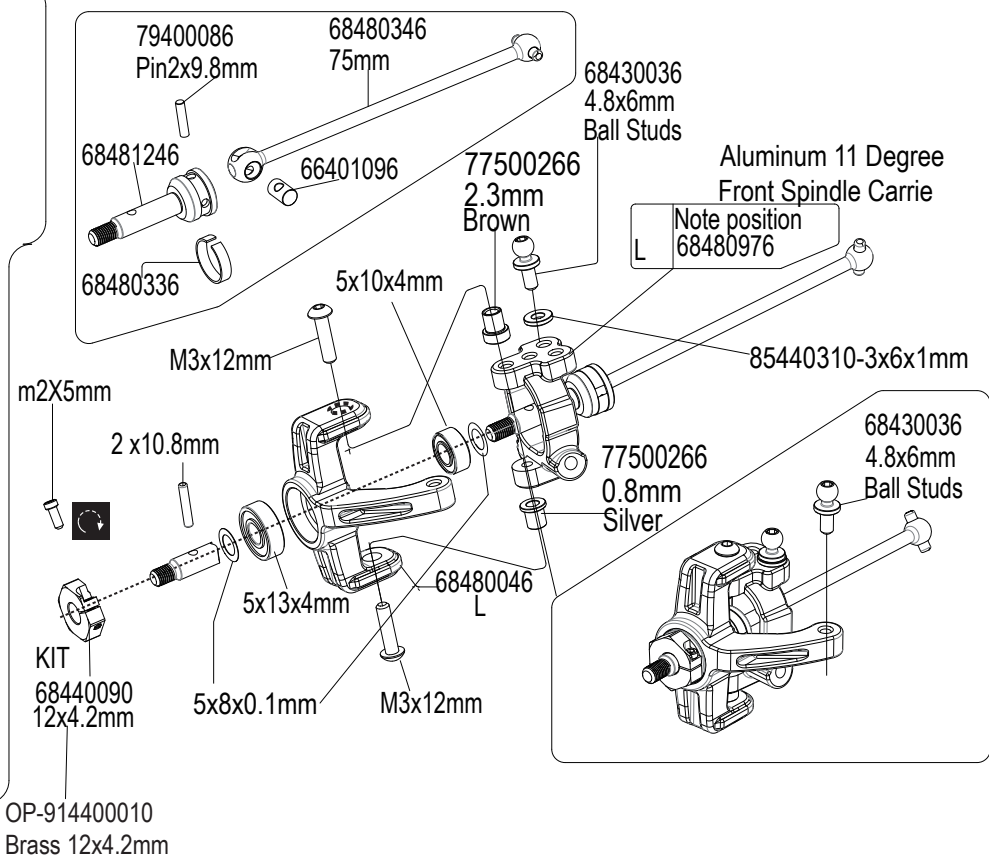

B2 Front Hub Carrier Assembly (Right Side)

Right Side



- 2
Button Head Cap Screw
M3x12mm-80400206
- 2
4.8mmx6mm
Ball Studs-68430036
- 1
5x10x4mm zz Ball Bearing
89430010
- 1
5X13X4mm zz Ball Bearing
89430020
- 1
79400086-Pin2x9.8mm
- 1
79400016-Pin 2 x10.8mm
- 2
Shim 5x8x0.1mm-85440090
- 1
87400066-m2X5mm

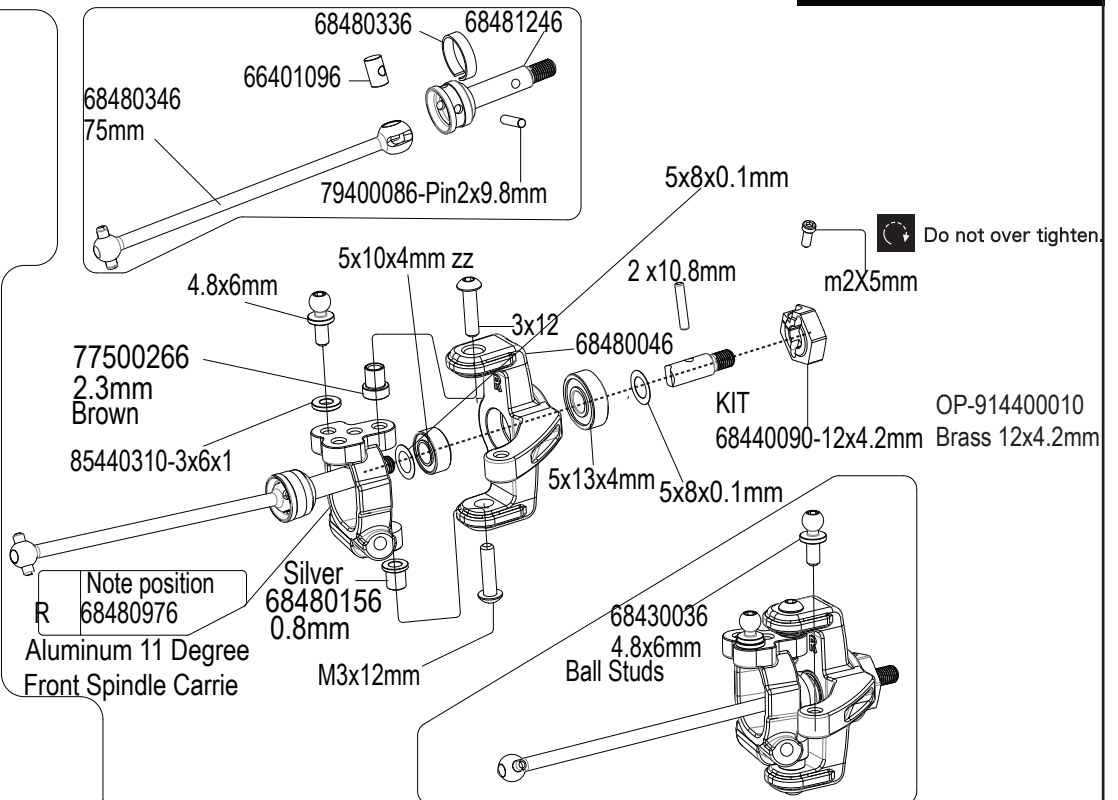



B3 Suspension Mount Installation- Sway Bar Installation

- 4
M3X6mm Flat Head Screw
82400016
- 2
M2.5X5.5mm
80400016
- 2
M3X8mm Button Head Cap Screw
80400036
- 2
M3X3mm Set Screw
87400016
- 2
M3X6mm Set Screw
78400026
- 2
M3X10mm Set Screw
87400026
- 2
Pin 3x36.8mm-79400036
- 2
Pin 3x52mm-79480036

- 2
Shim 3X4.6X0.1mm
85440220

0mm
Set Screw
M3X10mm
87400026

68480756
2.1mm

77430036
gray

**Assemble
2 sway bar rod.**

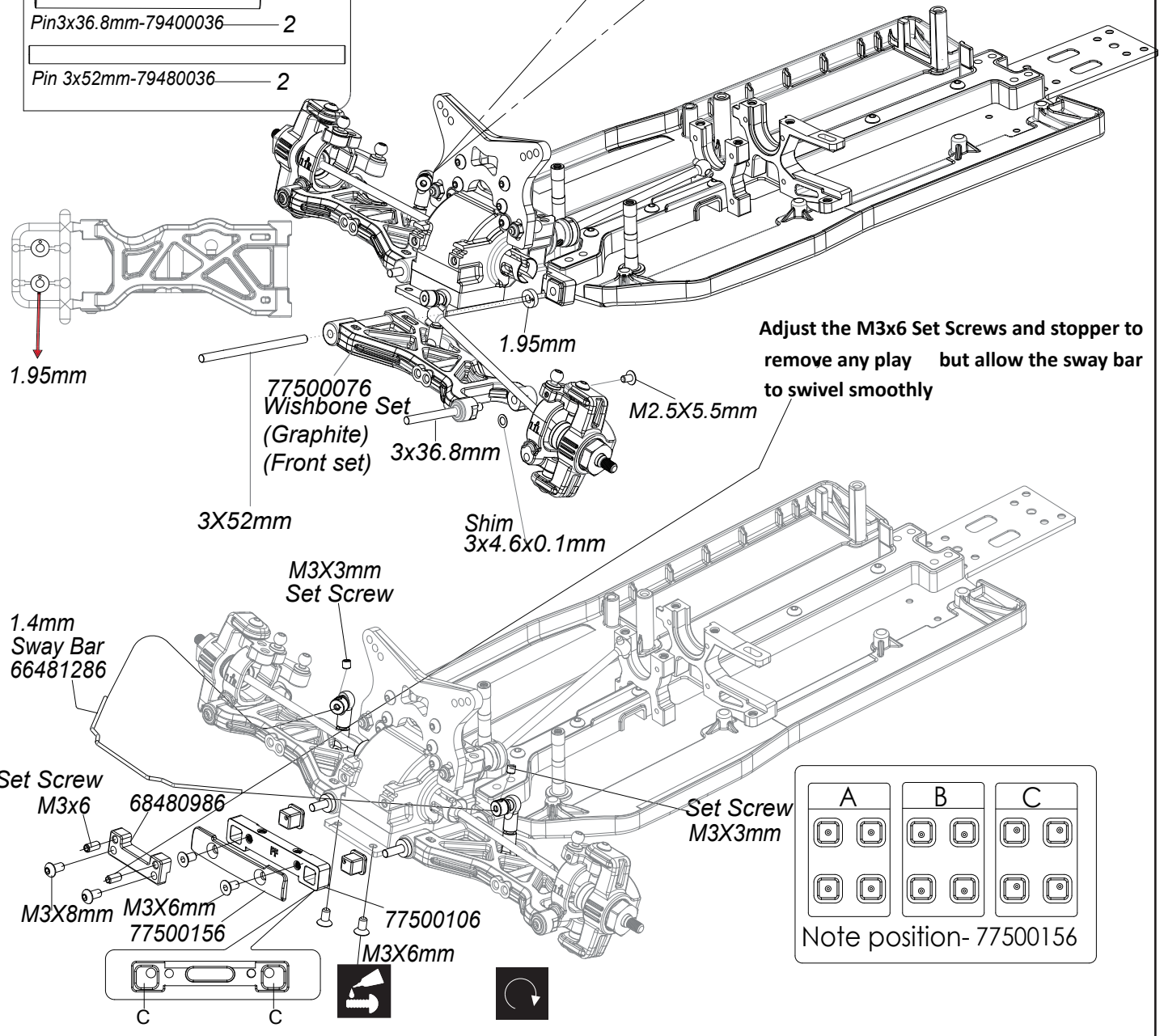
Part Bags used.



Assemble left and right sides the same way.



Tighten securely.



Apply threadlocker (screw cement)



BAG B

B4 Front Upper Turnbuckle Assembly

One side is reverse threaded.

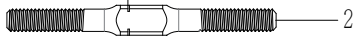

36mm Turnbuckles
77430016

"Assemble 2 front links and 2 steering rod links"

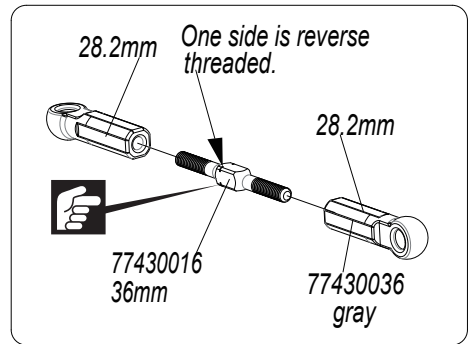
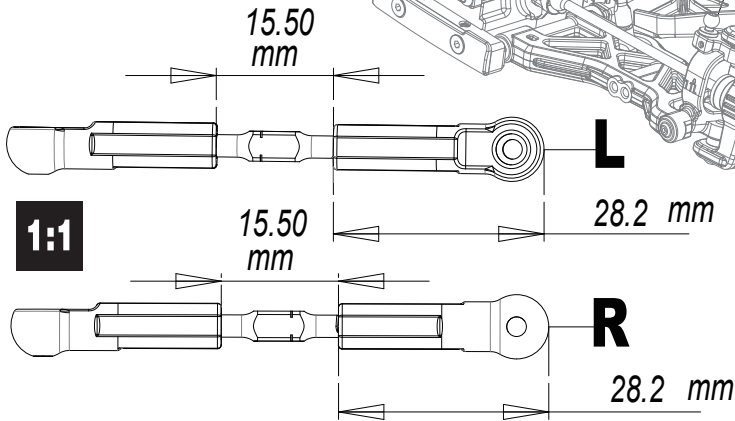
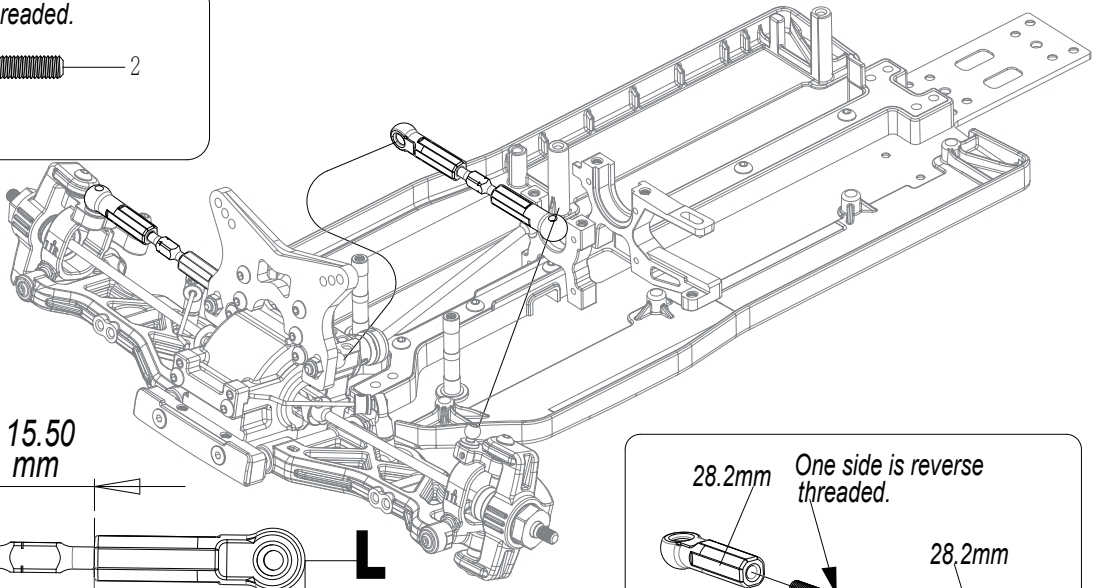

BAG B

B5 Gearbox-Reinforcement - Front

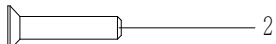

3x15mm Flat Head Screws
82400176

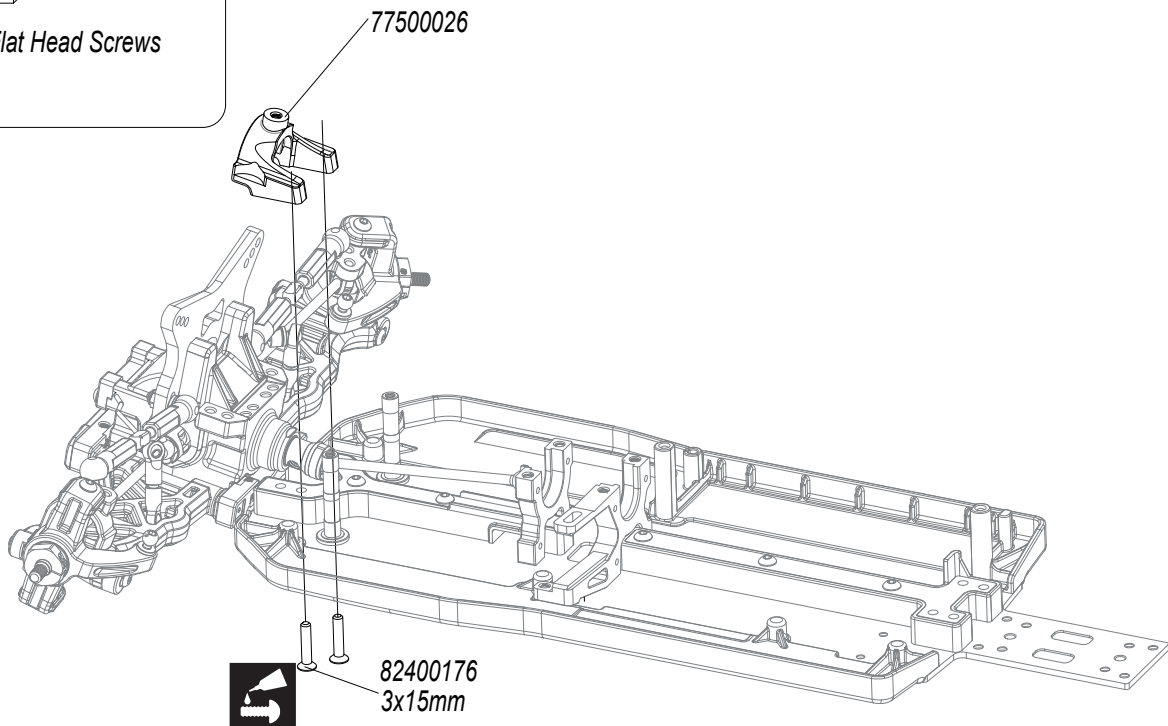

Part Bags used.



Note the direction.



Apply threadlocker (screw cement)

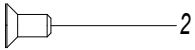
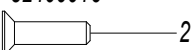
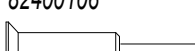

C1 RF Suspension Mount

-  4
M3X10mm Button Head Cap Screw
80400046
-  2
M3X6mm Flat Head Screw
82400016
-  2
M3X10mm Flat Head Screw
82400106
-  2
M3X15mm Flat Head Screw
82400176

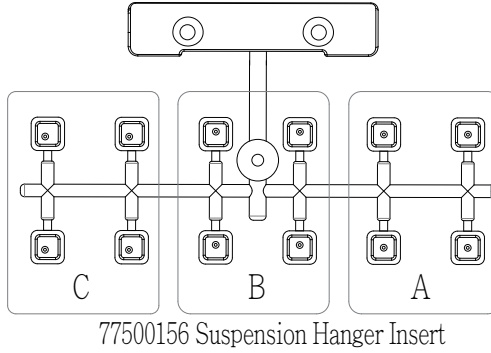
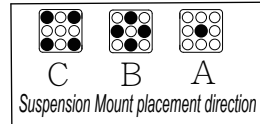

77500036
Gearbox Reinforcement Block - Rear
place onto Gearbox before locking in place.

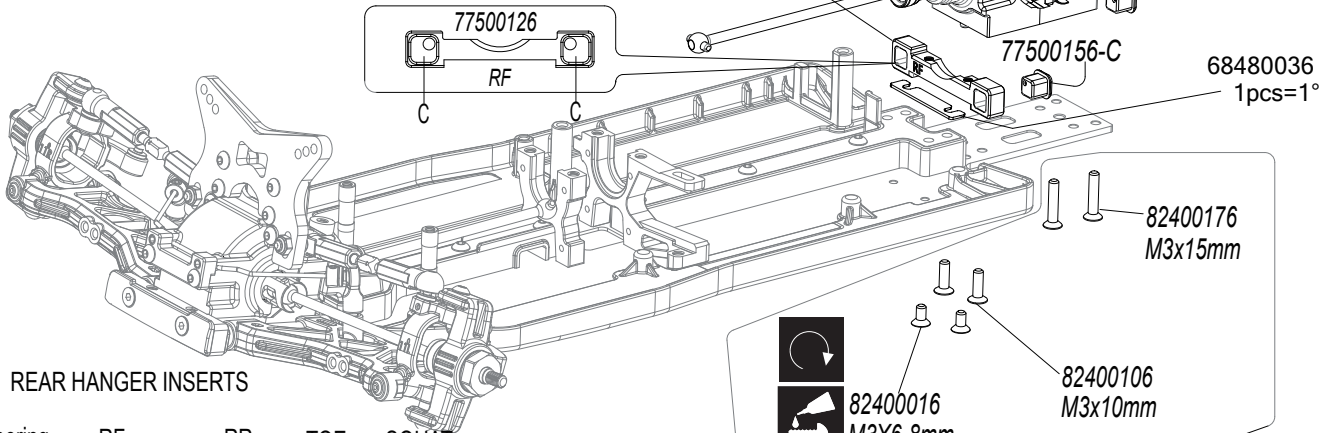
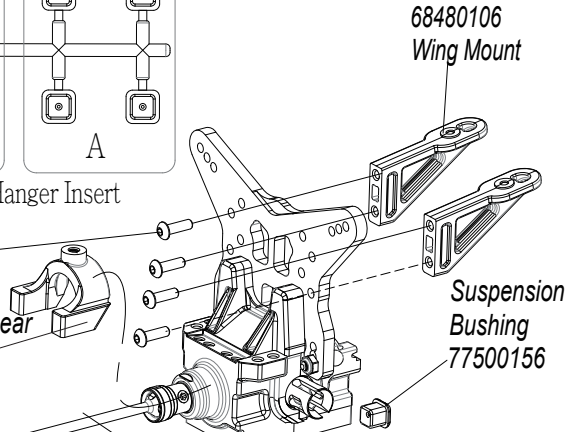

REAR HANGER INSERTS

Numbering	RF	RR	TOE	SQUAT
R-1			+1.6	0
R-2			+1.6	+0.7
R-3			+1.6	+1.4
R-4			+1.6	-0.7
R-5			+1.6	0
R-6			+1.6	+0.7
R-7			+1.6	-1.4
R-8			+1.6	-0.7
R-9			+1.6	0
R-10			+1.6	0
R-11			+0.8	0
R-12			0	0
R-13			+2.5	0
R-14			+1.6	0
R-15			+0.8	0
R-16			+3.0	0
R-17			+2.5	0
R-18			+1.5	0
R-19			+3.5	+2



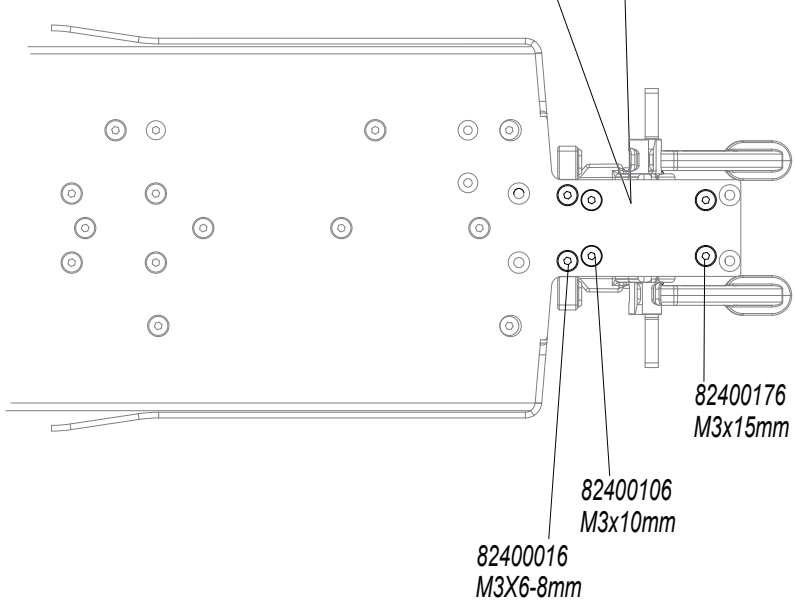





Note:  (1) SB401 Plastic Antisquat Shims=1mm=1Degree.

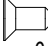
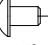

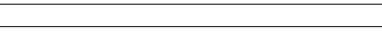
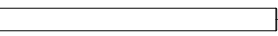

C2 Rear Left Hub Carrier Assmely

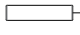
Assemble the right left side in the same manner.

-  2
m3x6mm Flat Head Screws
82400016
-  4
M2.5X4mm Button Head Screw
80400016
-  2
10x15x4mm zz Ball Bearing
89430030
-  2
5x13x4mm zz Ball Bearing
89430020
-  4
Shim 5x8x0.1mm
85440090
-  2
PIN(3x52mm)79480036
-  2
PIN(3x36.8mm)79400036
-  2
PIN(2 x 10.8mm)79400016
-  2
PIN(2 x 9.8mm)79400086
-  1
m2X5mm-87400066

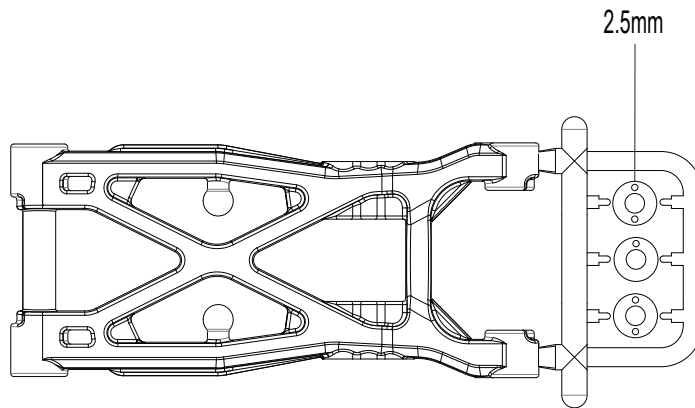
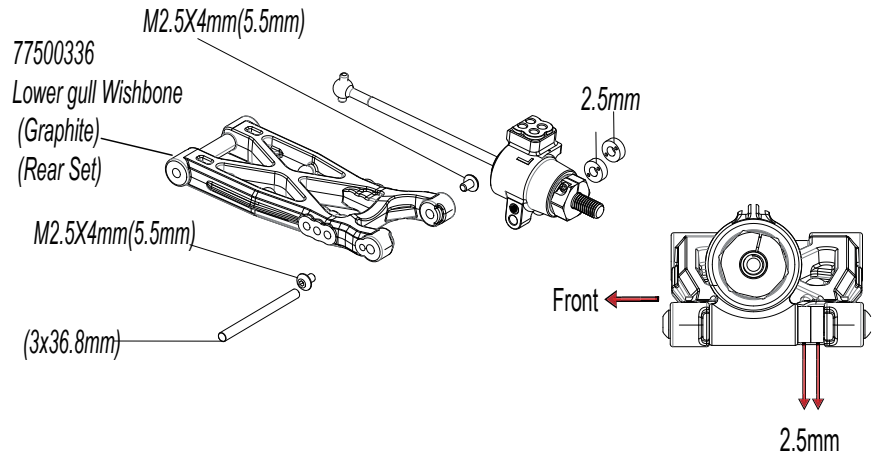
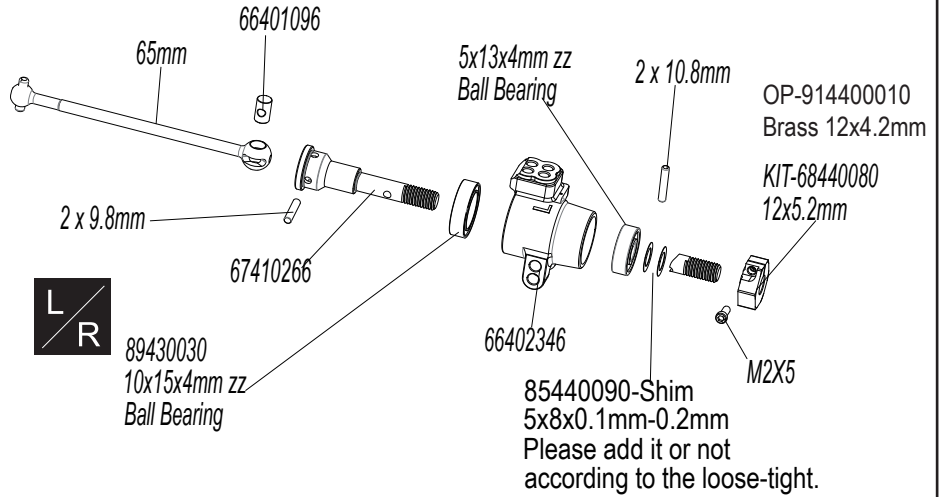



C3 Rear Left Hub Carrier Assmely

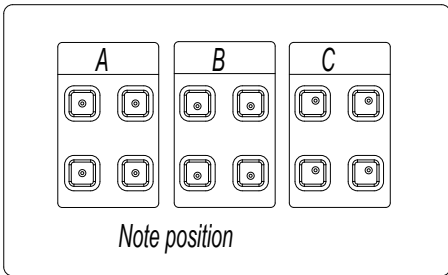

REAR HANGER INSERTS

Numbering	RF	RR	TOE	SQUAT
R-1			+1.6	0
R-2			+1.6	+0.7
R-3			+1.6	+1.4
R-4			+1.6	-0.7
R-5			+1.6	0
R-6			+1.6	+0.7
R-7			+1.6	-1.4
R-8			+1.6	-0.7
R-9			+1.6	0
R-10			+1.6	0
R-11			+0.8	0
R-12			0	0
R-13			+2.5	0
R-14			+1.6	0
R-15			+0.8	0
R-16			+3.0	0
R-17			+2.5	0
R-18			+1.5	0
R-19			+3.5	+2

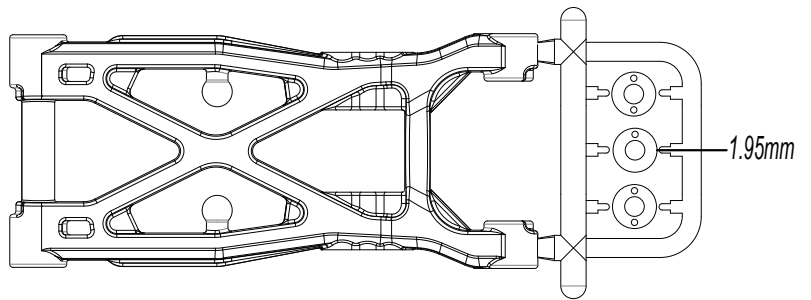
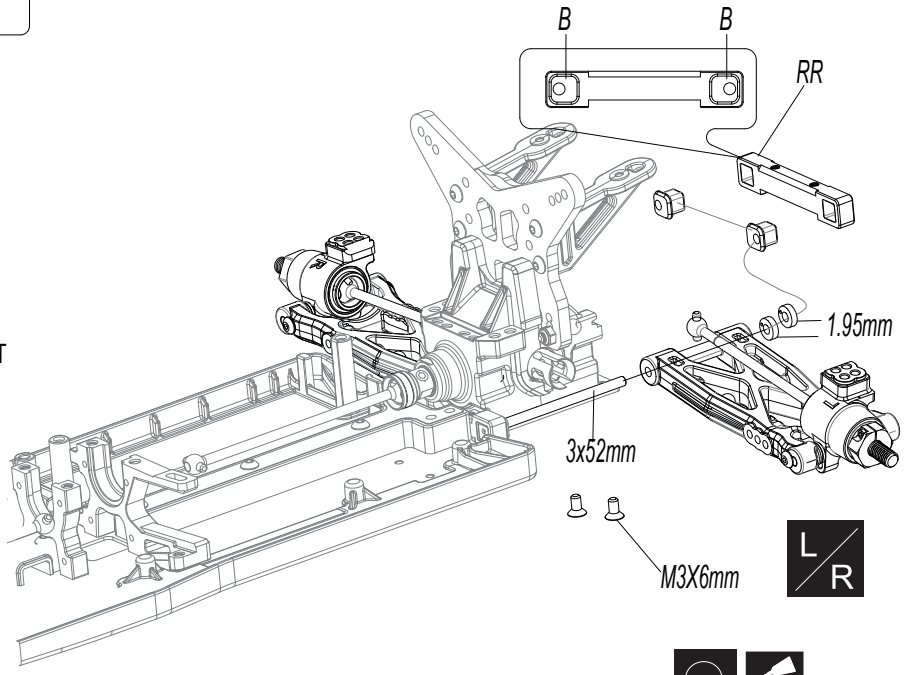

Note: (1) SB401 Plastic Antisquat
Shims=1mm=1Degree.

C4 Rear Upper Rod - Turnbuckle Assembly

BAG C

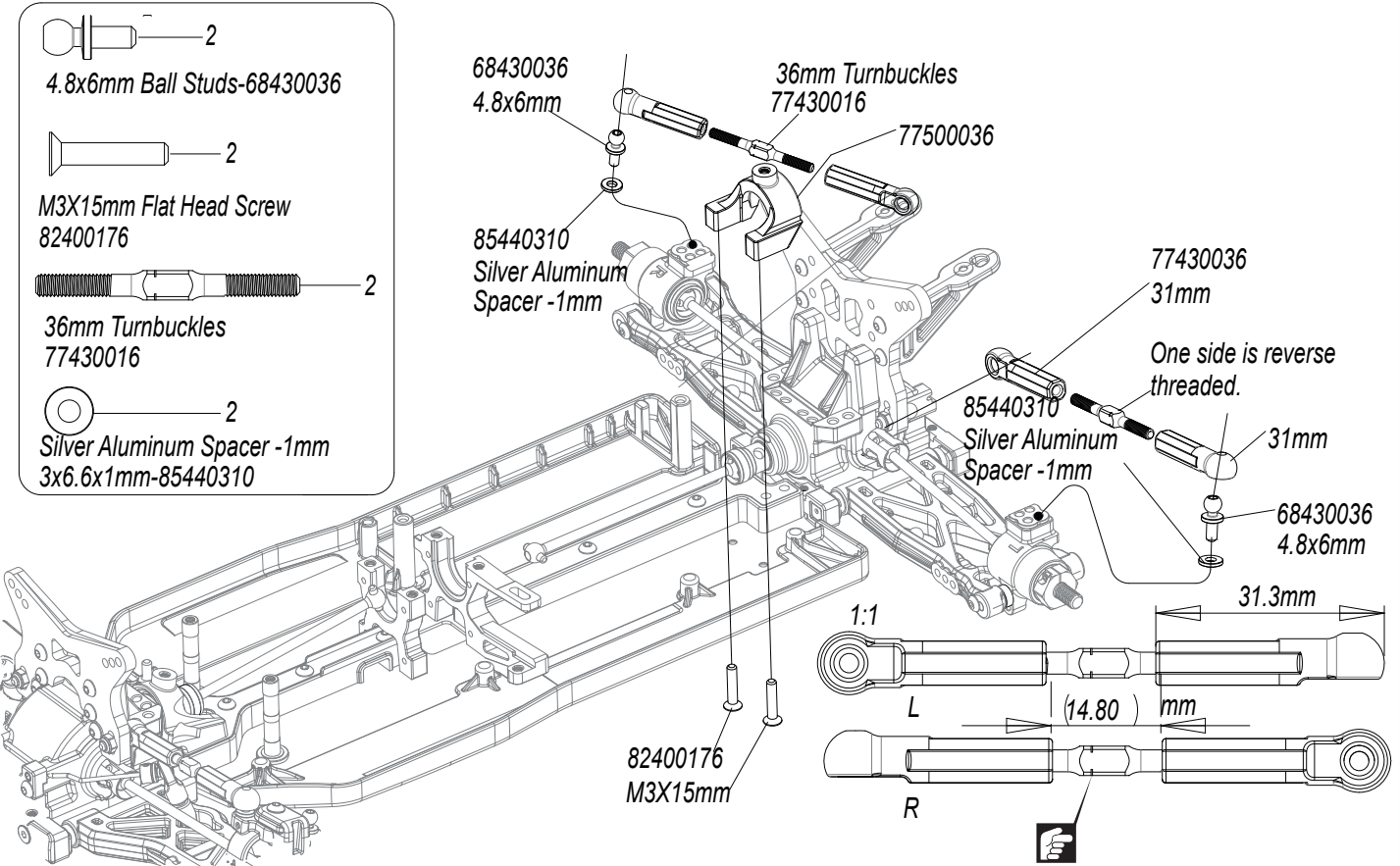

C5 Sway Bar Installation



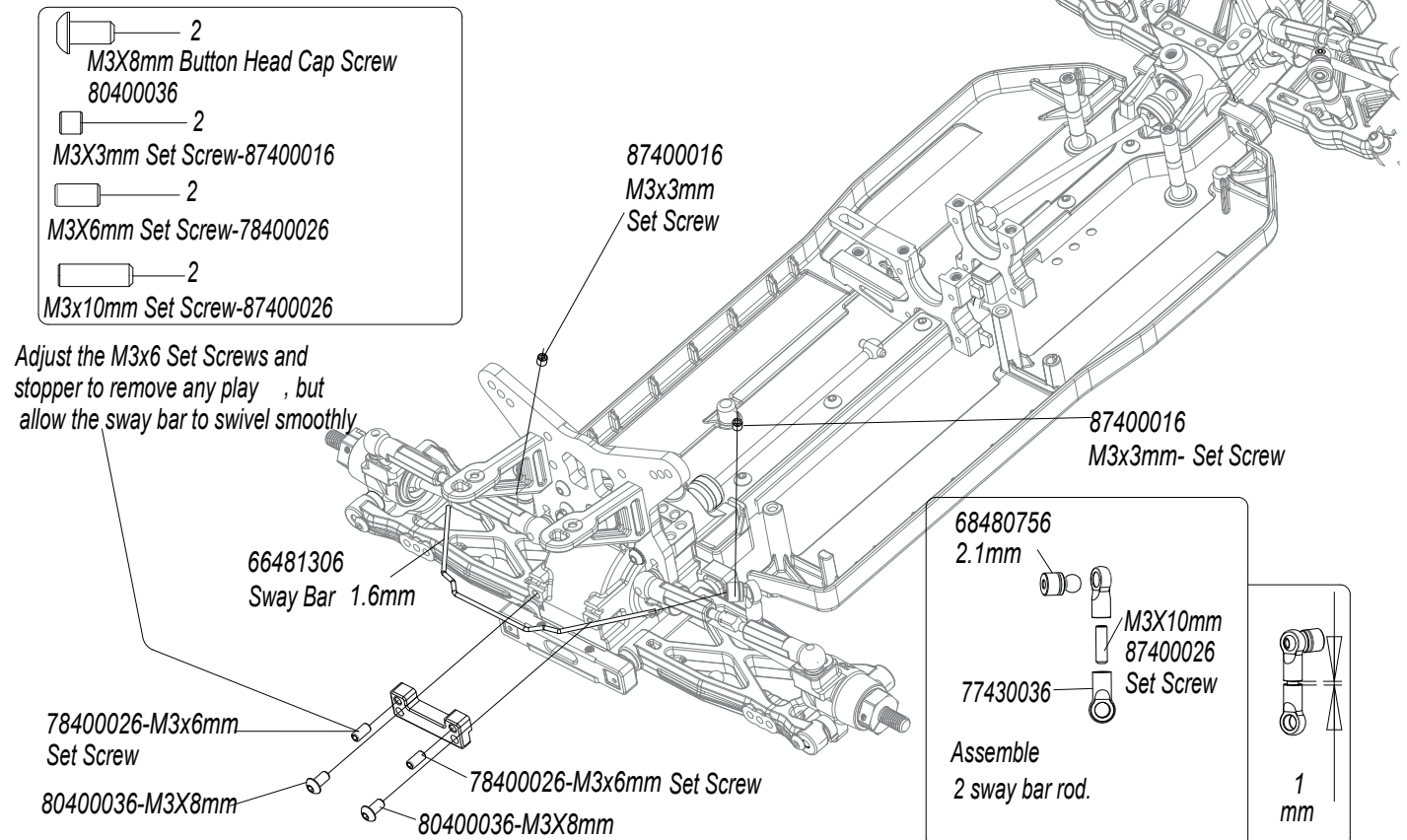



BAG C





D1 Bell Crank Installation

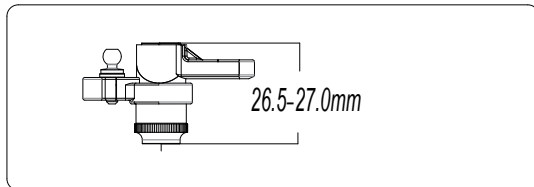
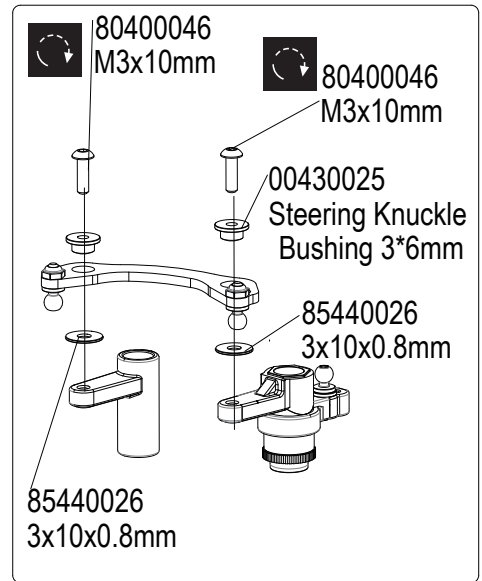
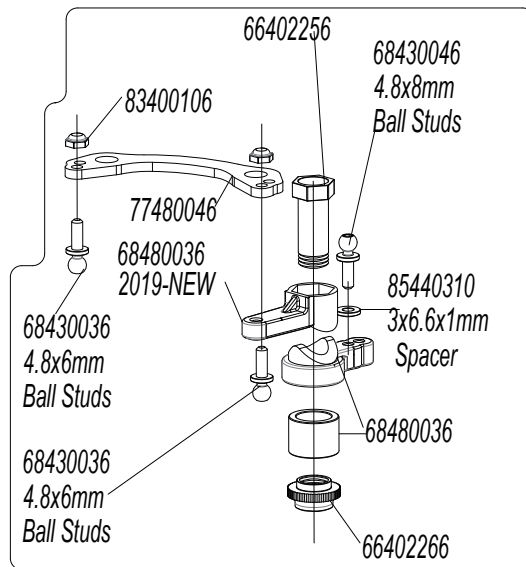

BAG D

-  3
4.8x6mm Ball Studs
68430036
-  1
4.8x8mm Ball Studs
68430046
-  2
M3 Lock Nut-83400106
-  2
shim-3x10x0.8mm-85440026
-  1
Silver Aluminum Spacer
3x6.6x1mm-85440310
-  2
M3x10mm-80400046
Button Head Cap Screw

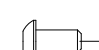

D2 Steering

BAG D

-  2
M3X6mm Button Head Screw
80400026
-  4
5x8x2.5mm zz Ball Bearing
66400756
-  2
Shim 5x8x0.2mm
85440010

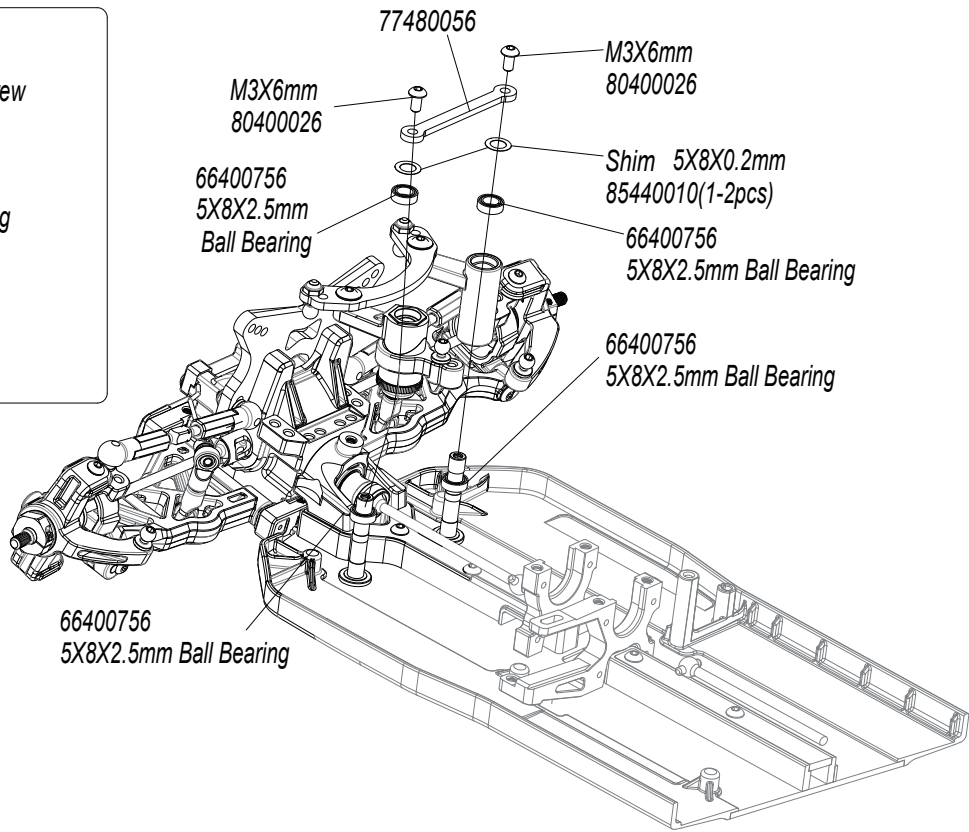



D3 Turnbuckle Assembly-Steering Rod -Servo Rod

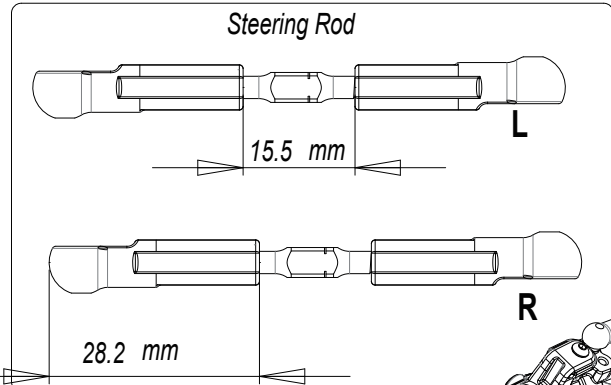
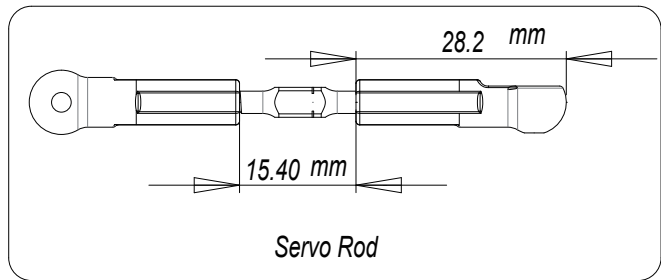
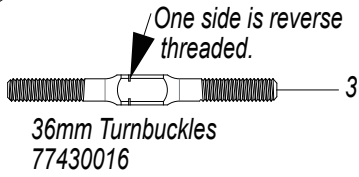

Assemble 2 front and 2 sway bar rod

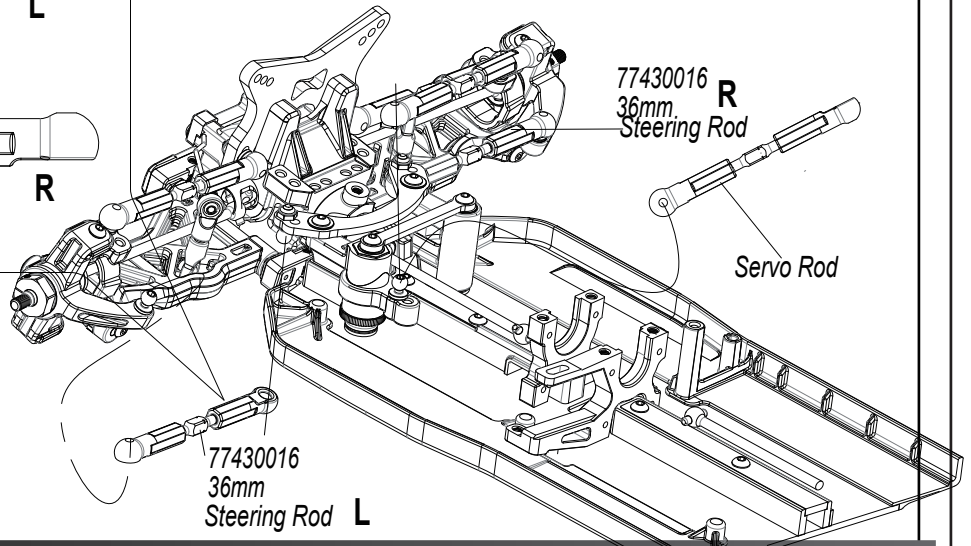

D4 Steering Servo



- 4 M3X6mm Button Head Screw 80400026
- 4 M3X10mm Button Head Screw 80400046
- 1 M3x10mm Flat Head Screws 82400106
- 3 M3x6mm -82400016 Flat Head Screws
- 1 M3 Lock Nut
- 1 68430036 4.8x6mm Ball Studs
- 4 Silver Aluminum Spacer 3x6.6x1mm-85440310

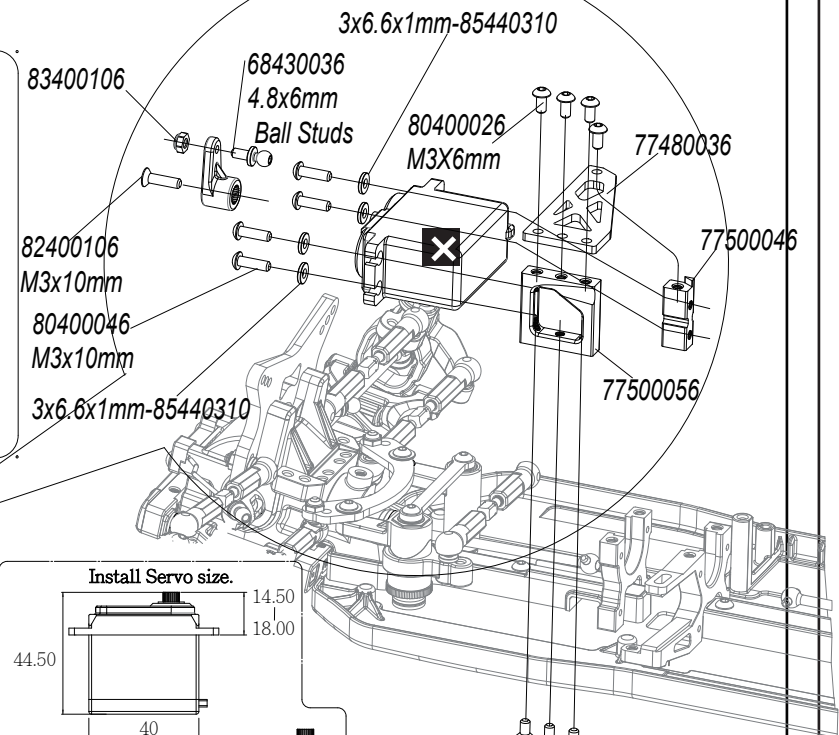

Servo Installation

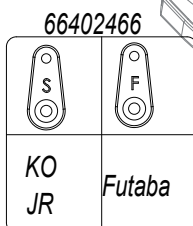

Make sure that the servo is centered before attaching the servo saver horn.
(Refer to your radio manual for more information)
Select the servo saver adapter matching the servo being used.

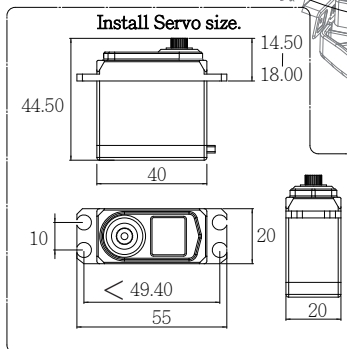

82400016 M3x6mm





D5 Center Mount Plate



BAG
D



4
M3 x6mm-8040026
Button Head Cap Screw

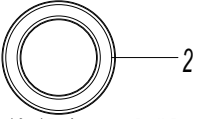

2
10x15x4mm zz Ball Bearing
89430030

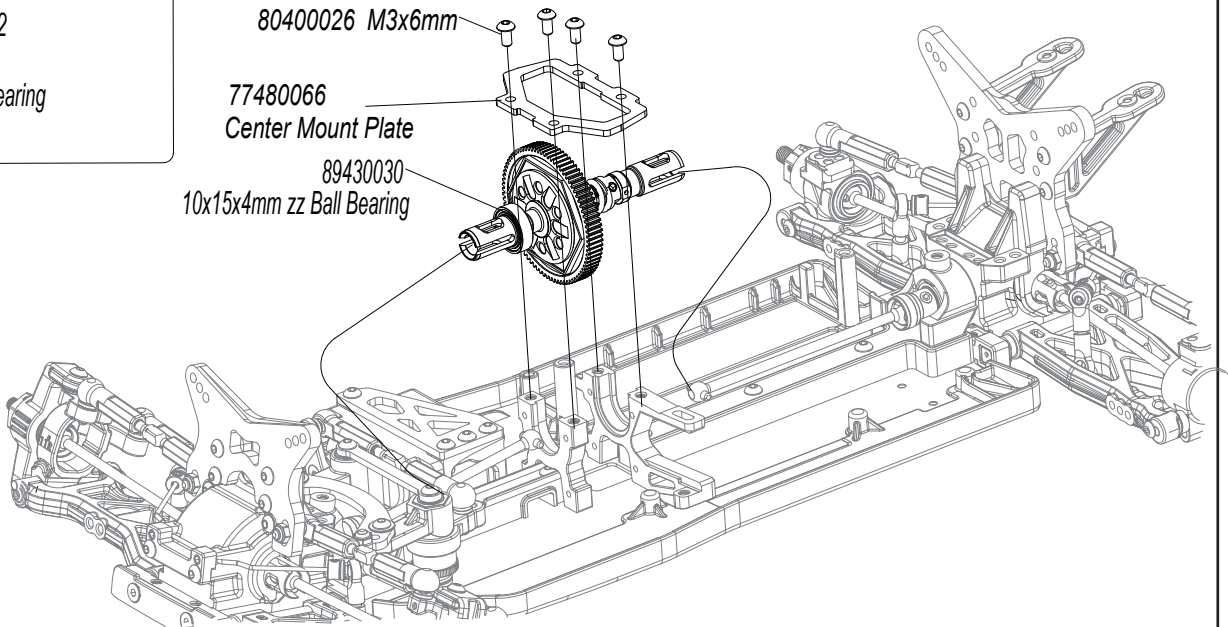

D6 Battery Plate Installation



BAG
D



2
M3 x6mm-8040026
Button Head Cap Screw

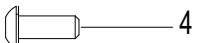

4
M3 x8mm-8040046
Button Head Cap Screw

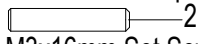

2
M3x16mm Set Screw
87400036

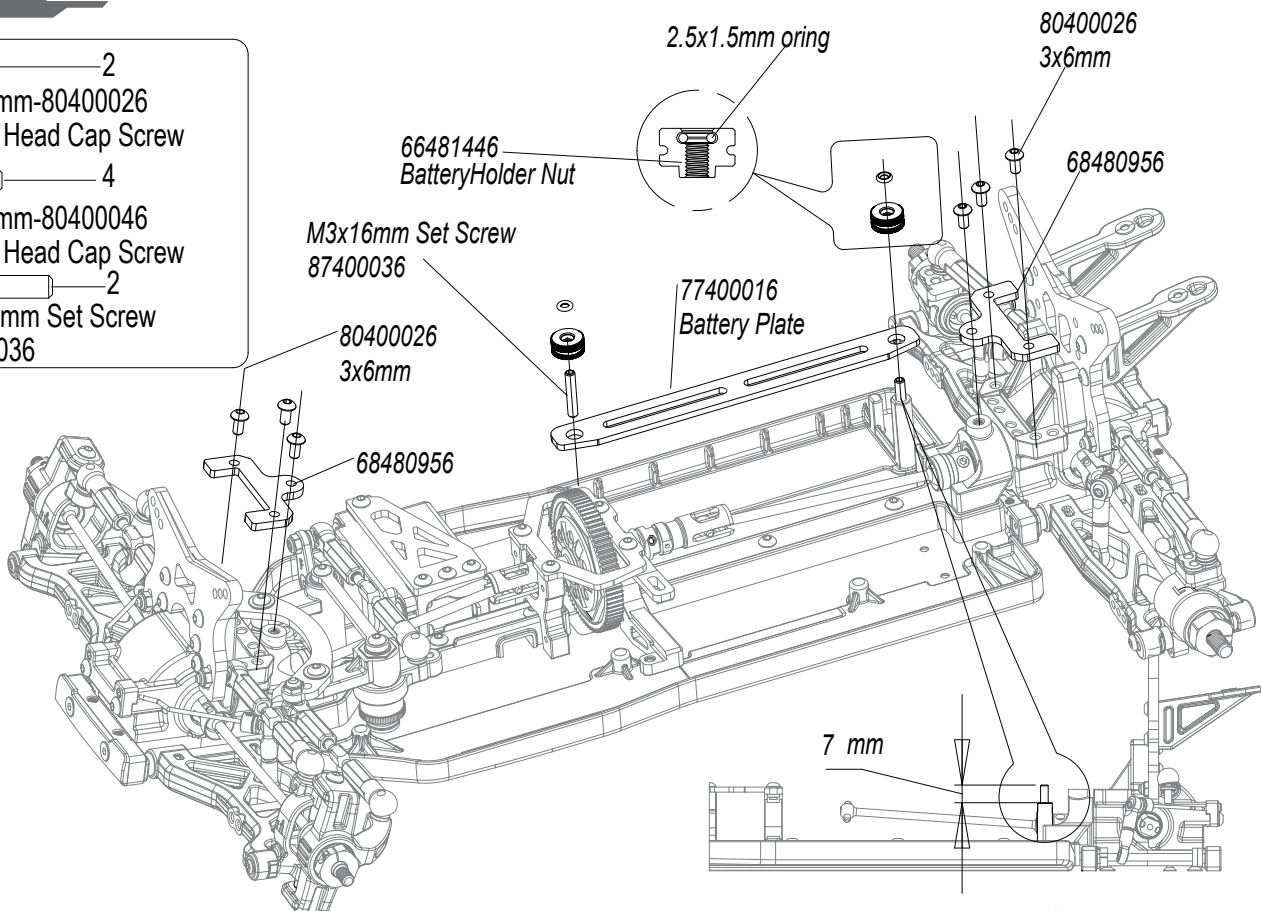

Part Bags used.



Must be purchased separately.



E1 Front & Rear Shock Assembly-R

BAG E

INCORRECT

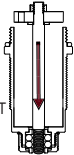

CORRECT

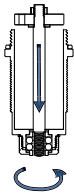

EXTREMELY IMPORTANT

Do not push the shock rod straight through the lower shock body assembly; O-ring damage may result.

Twist the shock rod through the lower shock body assembly.

0.36mm

SETUP TIP:

The 0.36mm plastic shim is an option you can use depending on your racing conditions.

Adding the shim as shown will improve the lower shock seal and reduce shock oil leakage but the tighter seal will reduce the smoothness of the shock action.

Leaving out the shim will result in smoother shock action but there may be slight shock oil leakage.

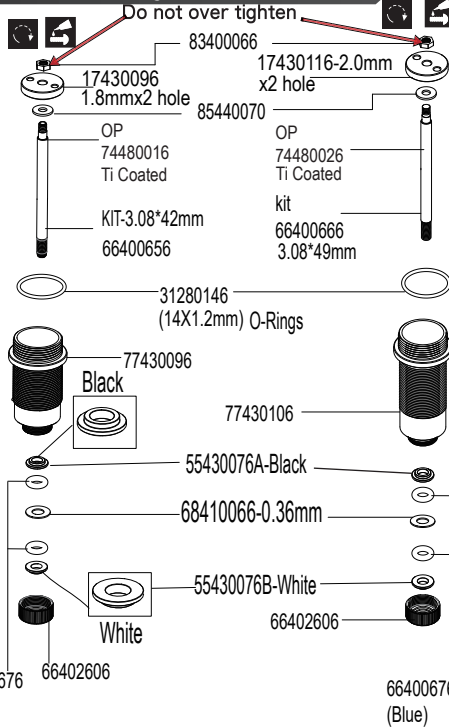

Front Buildx2

Rear Buildx2

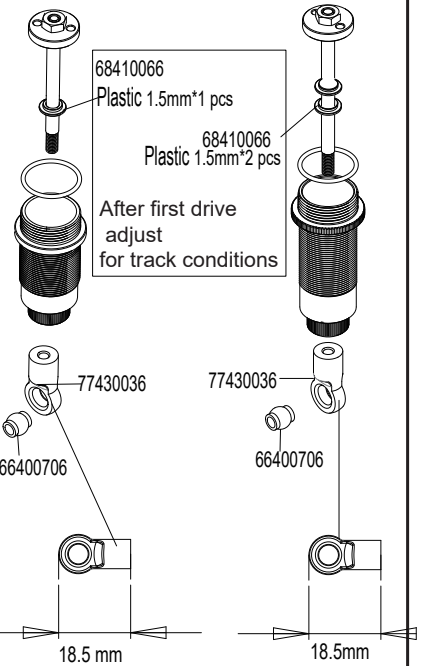

BAG D



Shock Ball---4pcs
66400706

After first drive adjust for track conditions

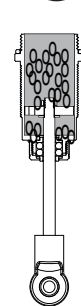

Slowly move up and down to remove air bubbles.

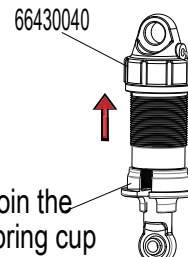

Slowly push the shock shaft all the way up, wipe away any excess oil that has seeped out, and screw in the bleeder screw.

Front Build x2
Rear Build x2

OP Shock Pistons

- 66480206-Machined Shock Pistons -1.3mm x 4 Hole (4pcs)
- 17430056-Machined Shock Pistons -1.4mm x 3 Hole (4pcs)
- 66400646-Machined Shock Pistons -1.4mm x 4 Hole (4pcs)
- 17430066-Machined Shock Pistons -1.6mm x 3 Hole (4pcs)
- 66480706-Machined Shock Pistons -1.6mm x 2 Hole (4pcs)
- 66480716-Machined Shock Pistons -1.7mm x 2 Hole (4pcs)
- 17430086-Machined Competition Shock Piston 0 Hole(4pcs)
- 17430046-Machined Shock Pistons -1.5mm x 3 Hole (4pcs)
- 17430076-Machined Shock Pistons -1.7mm x 3 Hole (4pcs)

Front Build x2

Rear Build x2

PR RACING			
2019 PR 1/10 Type R Shock Spring			
71530016-Type R Front Shock Spring Set (Not included-02530016)			
PART NO:	Color	kg/mm	lbs/in
02500096	Transparent	0.053	2.97
02500106	Blue	0.058	3.25
02500146	White	0.061	3.42
02500116	Red	0.063	3.53
02500126	Yellow	0.068	3.81
02530016	Green	0.075	4.20
02530026	Black	0.080	4.48
02530036	Blue Red	0.085	4.76
02530046	White Yellow	0.090	5.04
02530116	Green Black	0.098-(RT)	5.88-(RT)
71530026-Type R Rear Shock Spring Set (Not included-02530126)			
02500056	Transparent	0.030	1.80
02500066	Blue	0.035	2.10
02500136	White	0.037	2.22
02500076	Red	0.040	2.40
02500086	Yellow	0.045	2.70
02530056	Green	0.050	3.00
02530066	Black	0.055	3.30
02530076	Blue Red	0.060	3.60
02530086	White Yellow	0.065	3.90
02530126	Green Black	0.073-(RT)	4.50-(RT)

OP

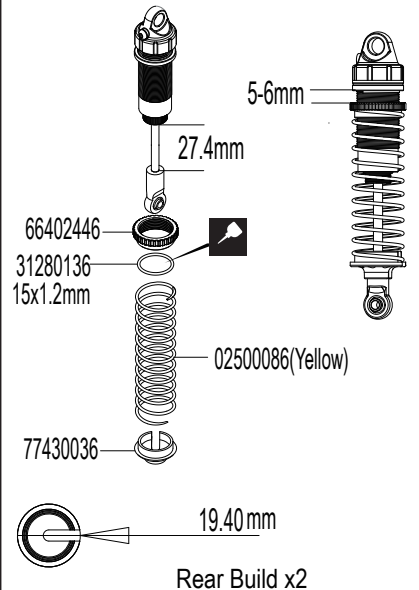
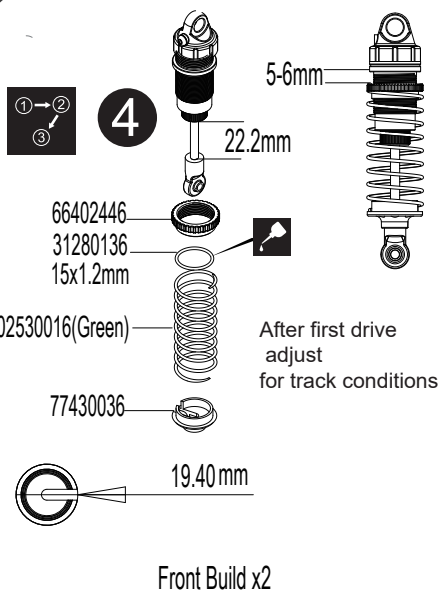

Part Bags used.



Apply threadlocker (screw cement)



Do not over tighten.



Apply oil.

E2 Front & Rear Shock Installation

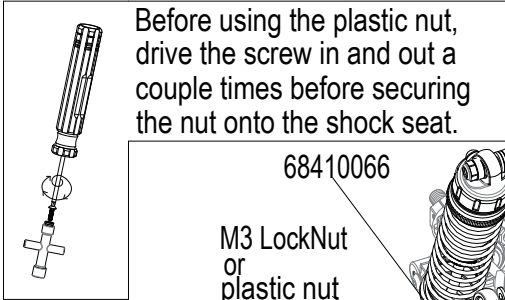
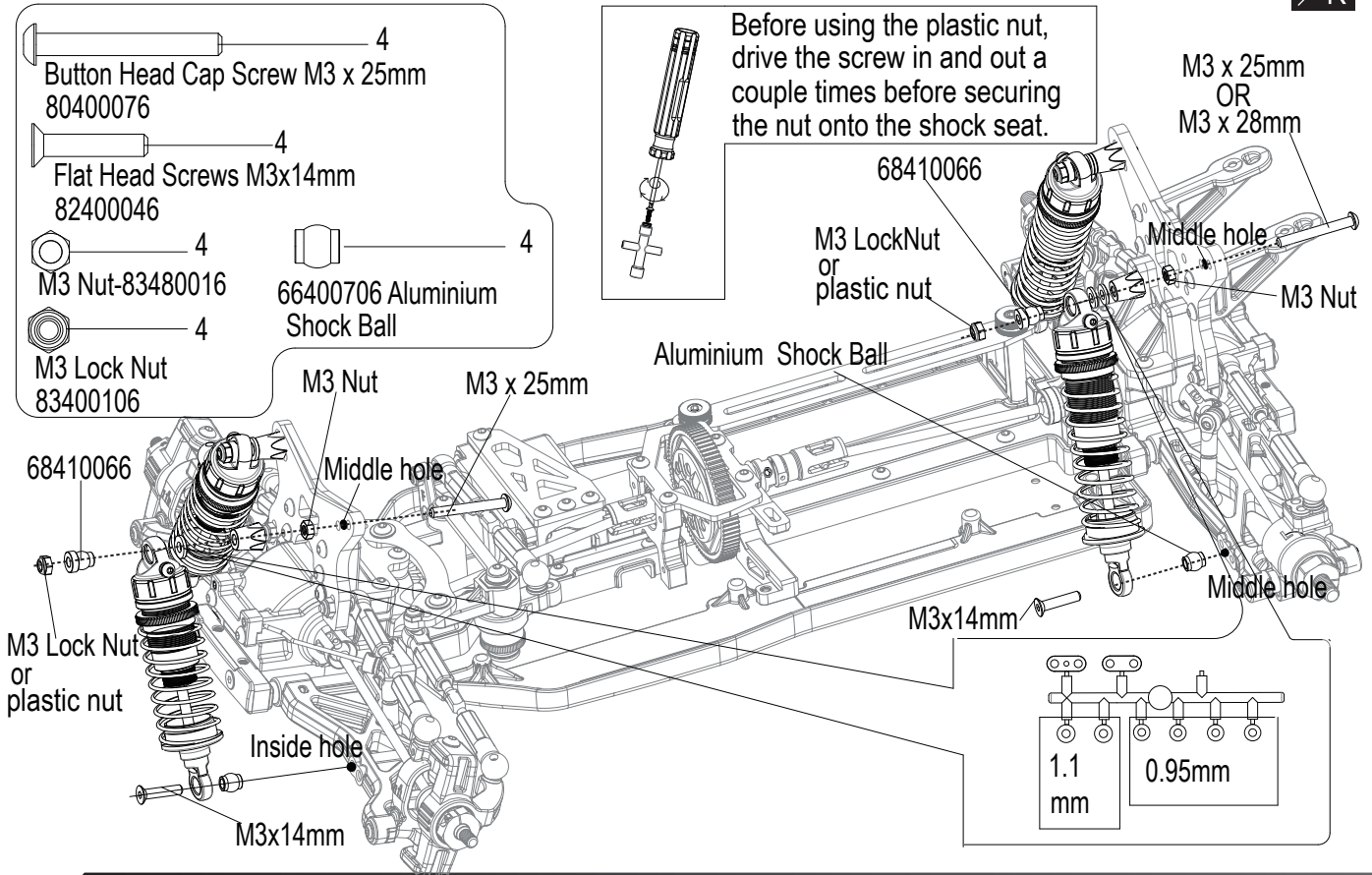

E3 Motor Installation

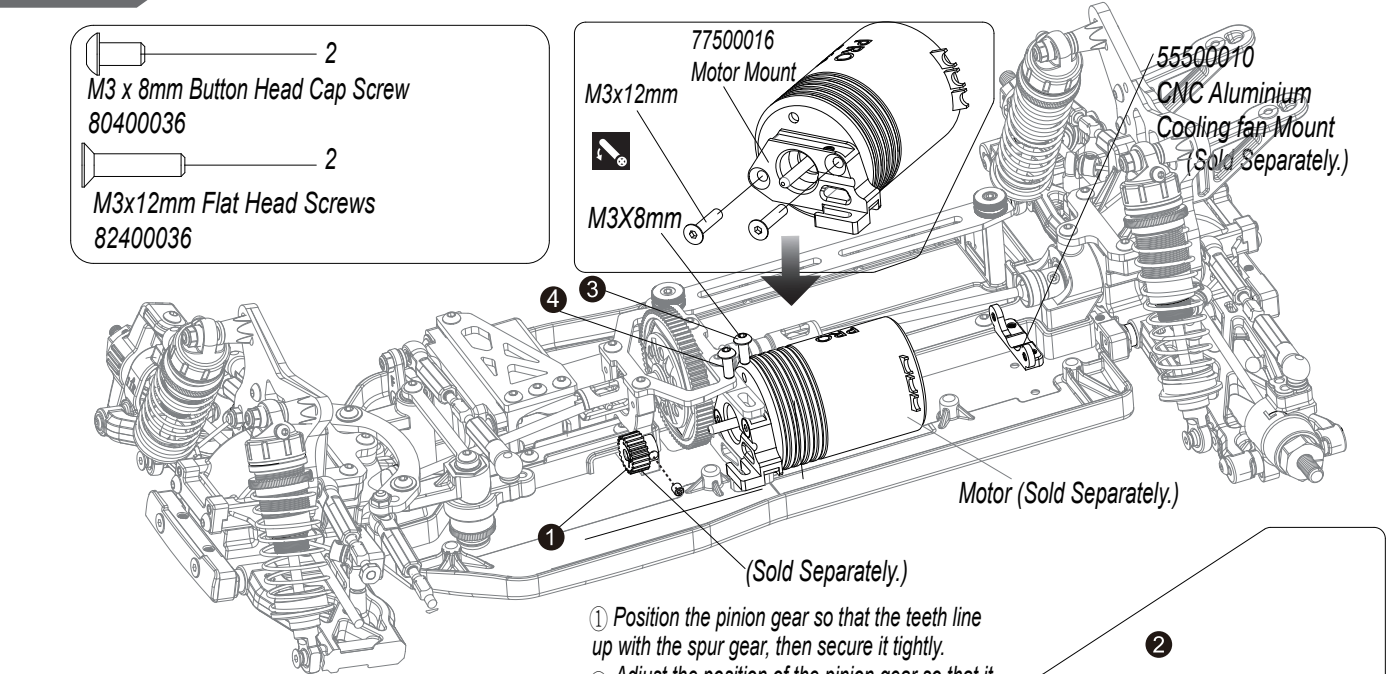

- ① Position the pinion gear so that the teeth line up with the spur gear, then secure it tightly.
- ② Adjust the position of the pinion gear so that it meshes properly the ③ screw, then tighten the ④ screw.

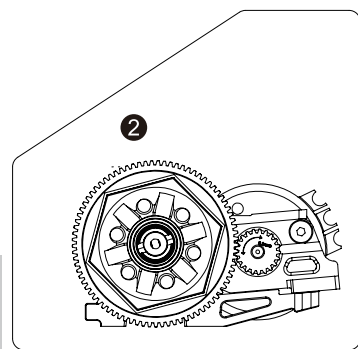



Pinion gears that will fit.

Pinion	17T	18T	19T	20T	21T	22T	23T	24T	25T	26T	27T	28T
77T(Standard)			10.54	10.01	9.53	9.10	8.70	8.34	8.01	7.70	7.41	7.15
80T(Standard)		11.56	10.95	10.40	9.90	9.45	9.04	8.67	8.32	8.00	7.70	
81T(Standard)	12.39	11.70	11.08	10.53	10.03	9.57	9.16	8.78	8.42	8.10		



E5 Mounting Tires Wheel Installation

-  2
M3x8mm Flat Head Screws
82400026
-  2
M4 Serrated flange nut
7mm Hex-83400076
-  2
M5 Aluminum Nut 7mm Hex
83000020

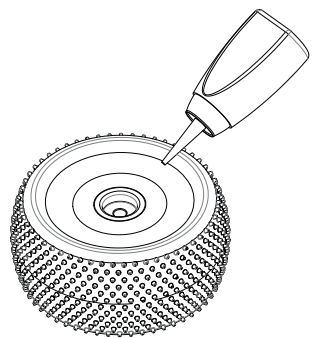
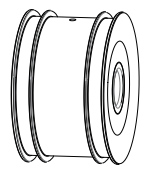
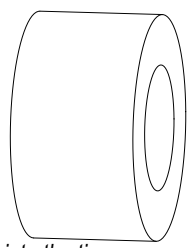
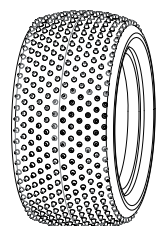

- Place the tire insert into the tire and tire onto the wheel.
- Tire and insert (Sold separsstely)
CA(Cyanoacrylate) glue sold separately.

- Pull the sidewall of the tire slightly away from the rim and apply CA(Cyanoacrylate) glue in between the tire bead and rim

● Body and Wing Cutting

- Wash the inside of the body with luke warm water and a mild soap or detergent (such as liquid dishwashing soap) prior to painting. Oil residue or dust will prevent the paint from adhering to the painting surface, and possibly cause the paint to peel later on. After washing, thoroughly dry the body to allow the paint to adhere properly.

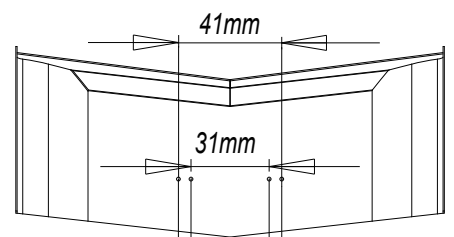

OP-68481226
Lightweight Body

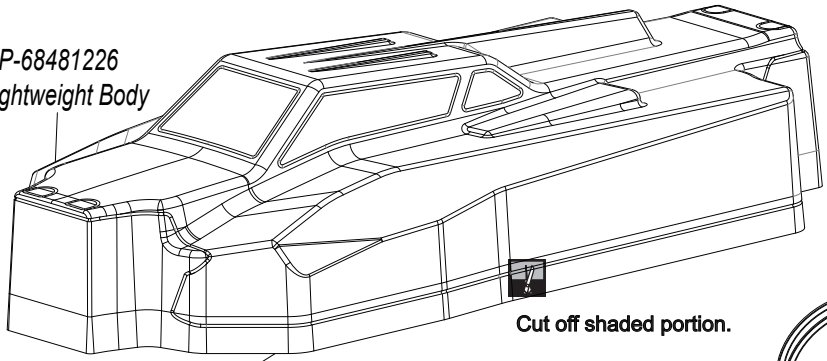

Cut off shaded portion.

82400026
M3x8mm

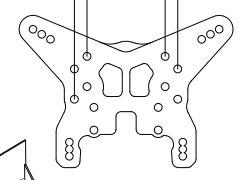

68480036

kit-68481076
Bodyshell and Sticker Set

77500276
Battery separator

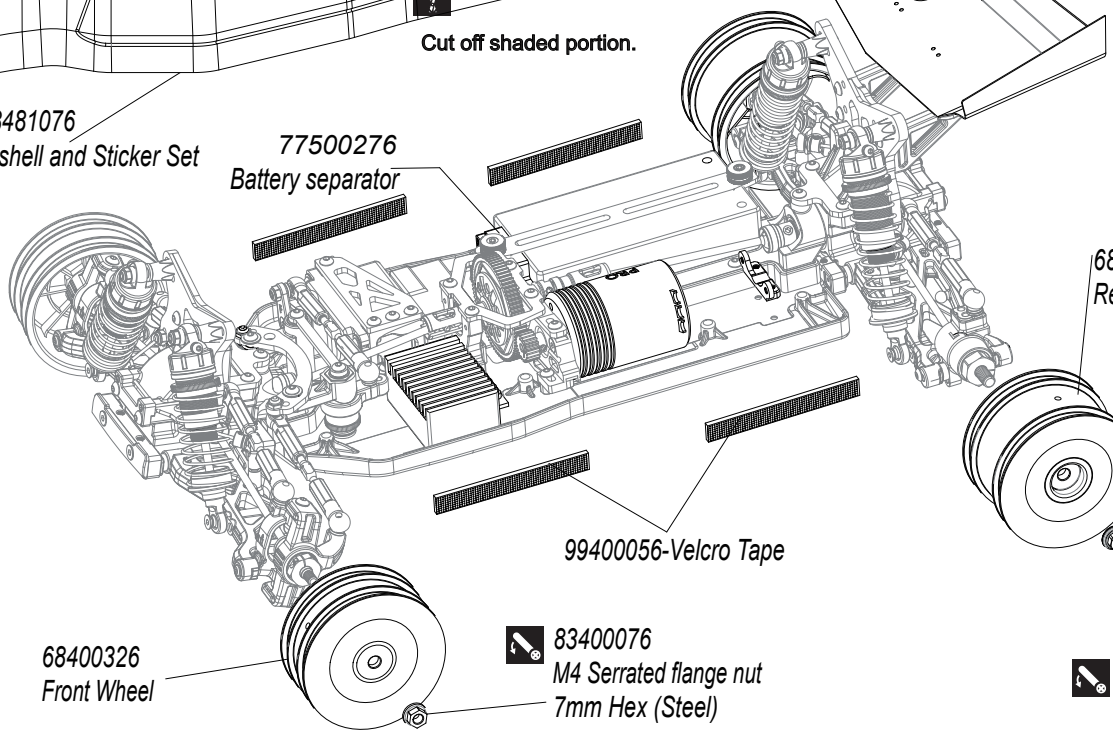



68400316
Rear Wheel



99400056-Velcro Tape

68400326
Front Wheel

 83400076
M4 Serrated flange nut
7mm Hex (Steel)

 83400116
M5 Nut 7mm Hex
(Aluminum)

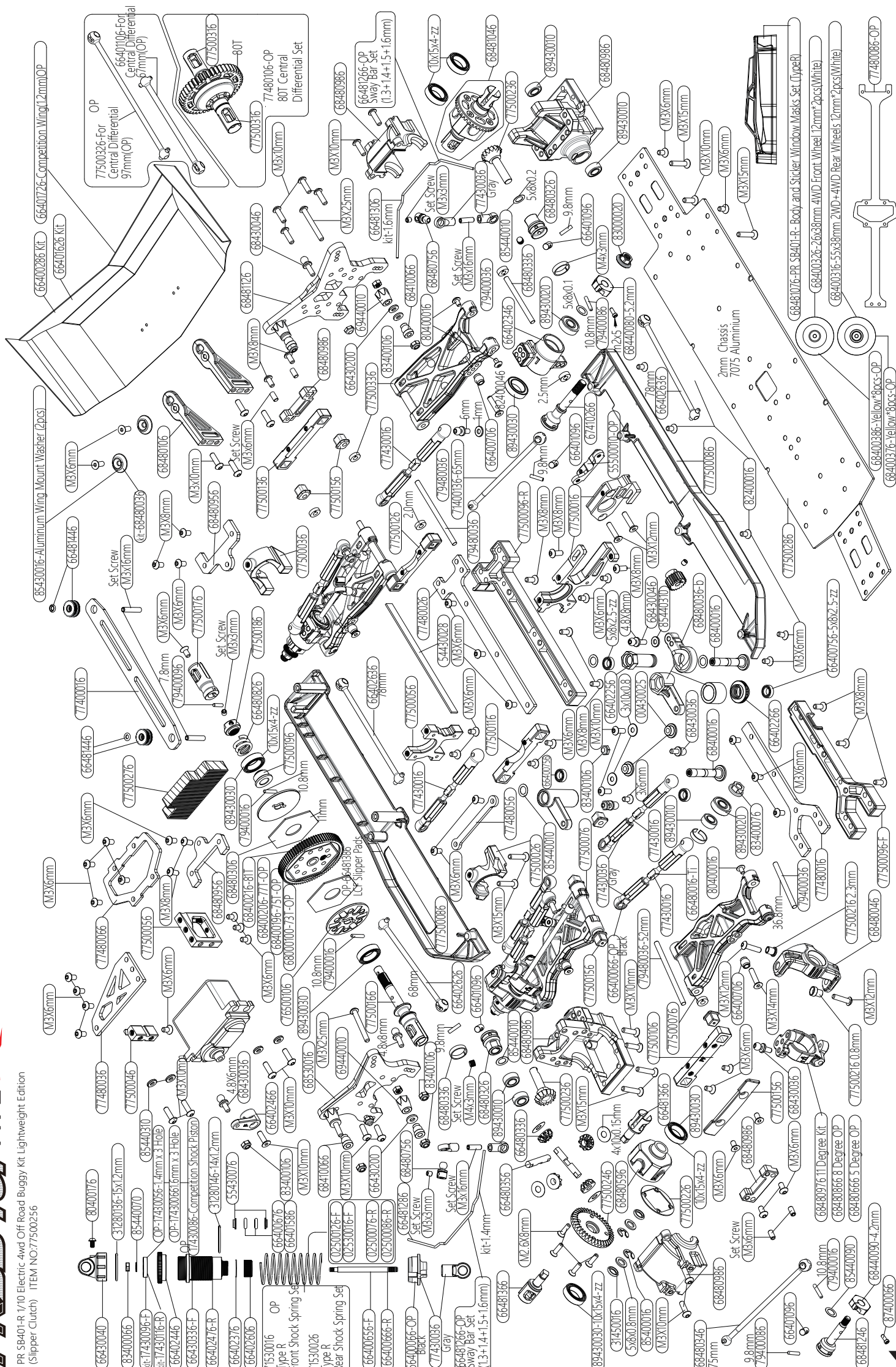

PR SB401 PR RACING TYPE R

PR SB401-R 1/10 Electric 4wd Off Road Buggy Kit Lightweight Edition (Slipper Clutch) ITEM NO:77500256

DRIVER _____ DATE _____

CIRCUIT

INDOOR OUTDOOR DIRT ASTROTURF CARPET
 GLASS WOOD WET DRY DUSTY SMOOTH
 BUMPY HARD PACKED CLAY BLUE GROOVE
 LOW TRACTION MED TRACTION HIGH TRACTION

FRONT

CAMBER _____

TOE IN OUT _____

RIDE HEIGHT _____

0.8mm
 2.3mm
 Silver 4.2 mm
 Black 5.2 mm
 Brass _____ mm

0.8mm
 2.3mm

OIL # _____

5° _____ mm
8° _____ mm
11° _____ mm

0.36mm Pom Shim

mm _____

O-Rings(Red)
 O-Rings(Blue)
 Type R Shock Spring _____

REAR

Silver 4.2 mm
 Black 5.2 mm
 Brass _____ mm

RF RR

OIL # _____

mm _____

0.36mm Pom Shim

mm _____

O-Rings(Red)
 O-Rings(Blue)
 Type R Shock Spring _____

Camber _____ mm

Ride Height _____ mm

MOTOR _____

GEAR Spur _____ T

Pinion _____ T

BATTERY _____

ESC _____

Battery Spacer

FRONT REAR

Adjusting slippers _____ mm

mm _____

mm _____

mm _____

mm _____

FRONT OIL# _____

REAR OIL# _____

Central Differential OIL# _____

TIRE _____

FRONT TIRE _____

INSERTS _____

WHEELS _____

REAR TIRE _____

INSERTS _____

WHEELS _____

OTHER

NOTE

A series of 20 horizontal dotted lines for writing notes.

PR SB401

PR RACING
TYPE **R**

PR SB401-R 1/10 Electric 4wd Off Road Buggy Kit Lightweight Edition
(Slipper Clutch Version)



mit
MADE IN TAIWAN



EMAIL / infopracing@gmail.com

1.7.1Version